

EMERGENCY EQUIPMENT

INV-ACC-SH-TAH21

INSTALLATION INSTRUCTIONS

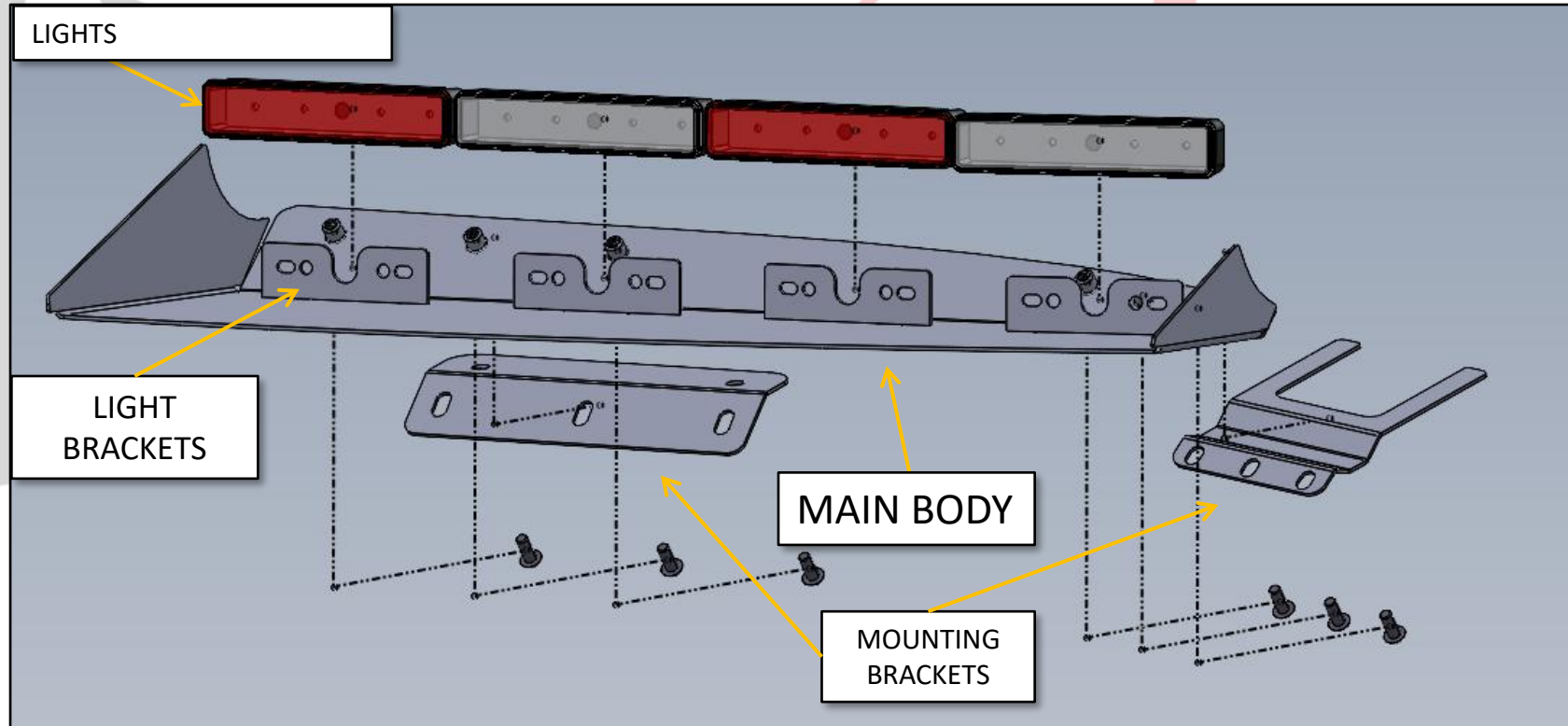

ASSEMBLY OF SHROUD

HARDWARE BAG TO INCLUDE:

- 1X MAIN BODY
- 2X MOUNTING BRACKET
- 6X 10-32 X ½ BHCS

EMERGENCY EQUIPMENT

BRACKET TO ATTACH TO

BRACKET TO ATTACH TO VISOR MOUNT

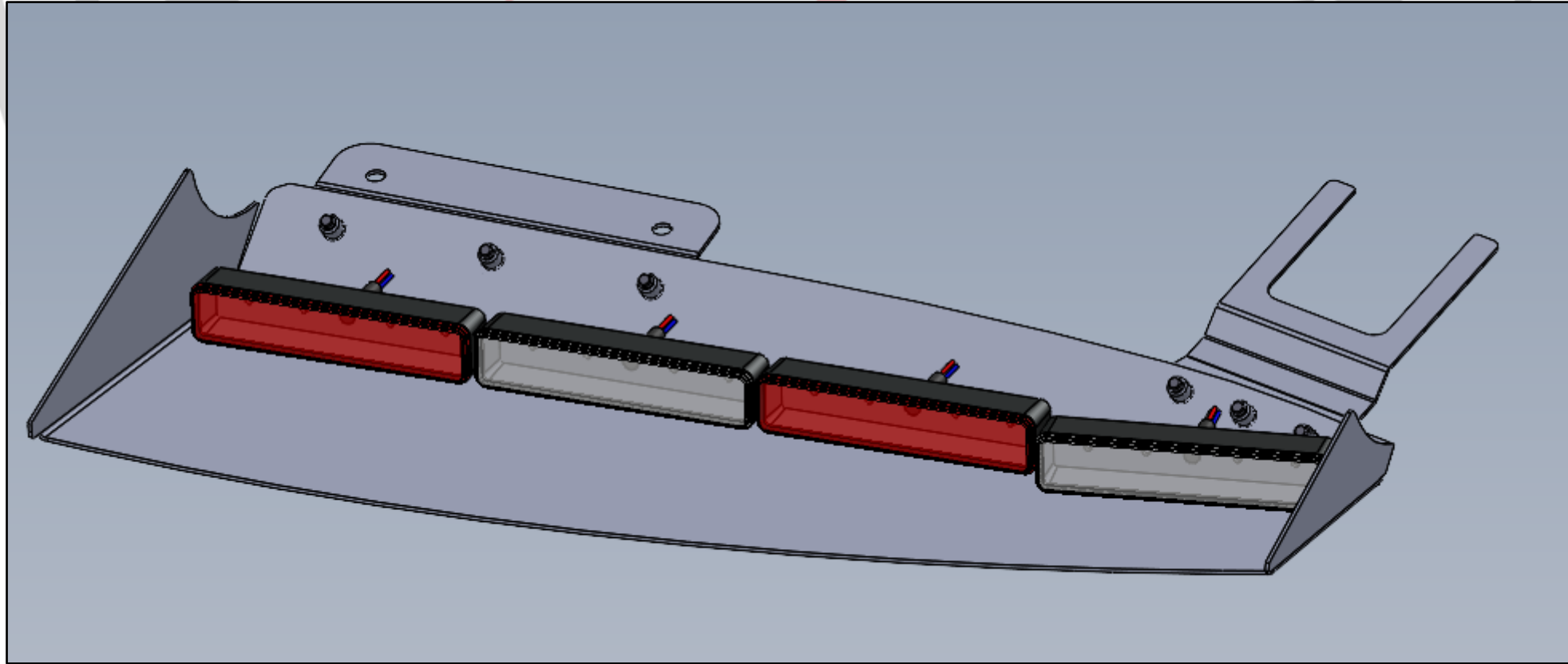



1616 MARLBOROUGH AVE. RIVERSIDE, CA 92507

FOR TECHNICAL ASSISTANCE WITH INSTALLATION OR
OTHER QUESTIONS, PLEASE CALL (951) 222-2270

OR EMAIL SUPPORT@IDSMP.COM

Thank you for your business!