

EMERGENCY EQUIPMENT

INV-CON-DN-DUR

INV-ACC-SVL-DUR

INSTALLATION INSTRUCTIONS

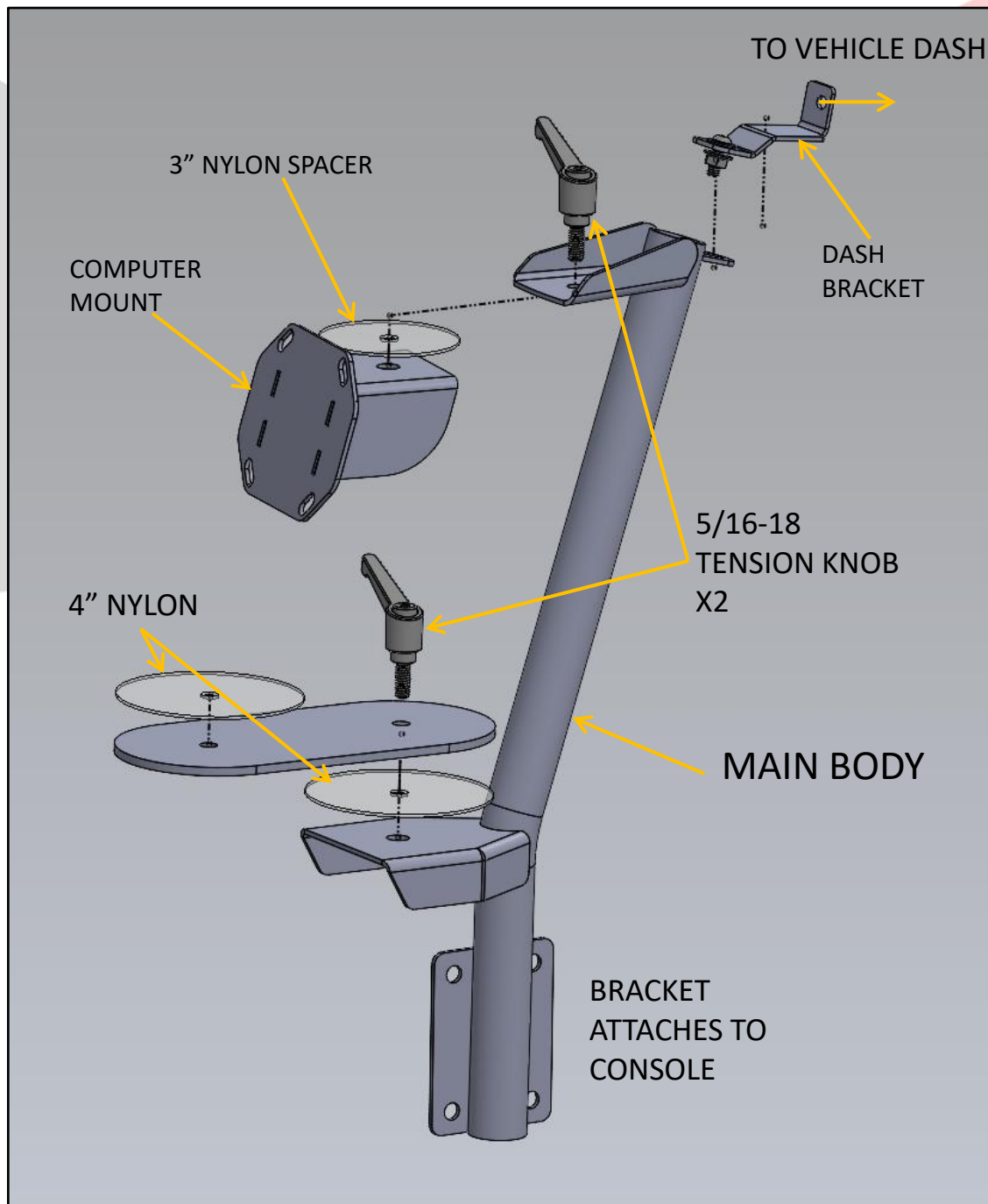

## ASSEMBLY OF SWIVEL SCREEN

NYLON WASHERS INCLUDED TO PREVENT BINDING OF POWDERCOATED PARTS

HARDWARE BAG TO INCLUDE:

- 1X MAIN BODY
- 1X DASH BRACKET
- 1X TABLET MOUNT
- 1X PIVOT ARM
- 2X 5/16-18 TENSION KNOBS
- 5X 1/4-20 BHCS
- 6X 1/4" WASHERS
- 1X 1/4-20 KEP NUTS
- 2X 4" NYLON SPACERS
- 1X 3" NYLON SPACER

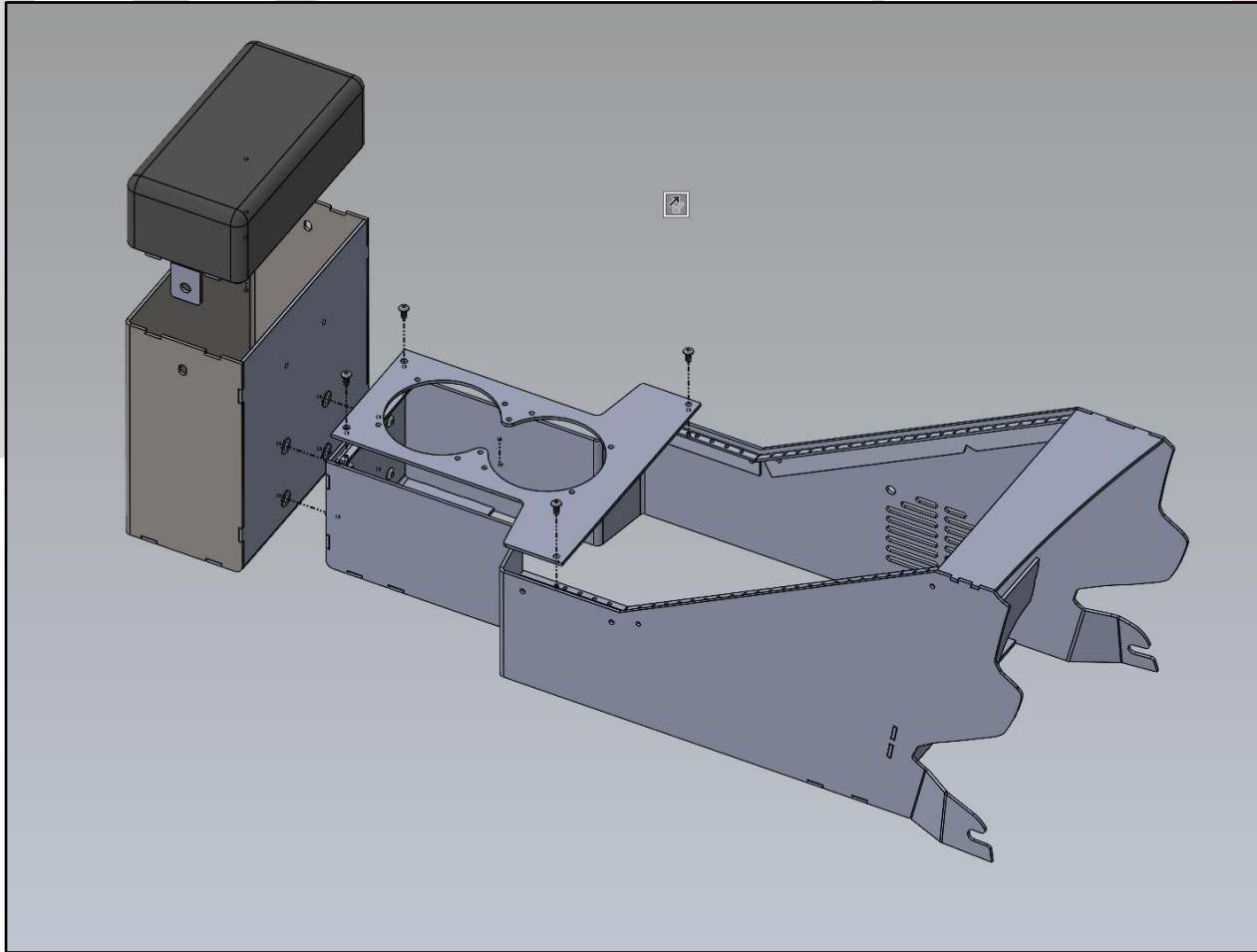

## Assembly of Console

### HARDWARE BAG TO INCLUDE

4X  $\frac{1}{4}$ -20 NUTSERTS

4X  $\frac{1}{4}$ -3/4 BHCS

4X 1/4- WASHERS

20X T15 X #8 CONSOLE SCREWS

EQUIPMENT

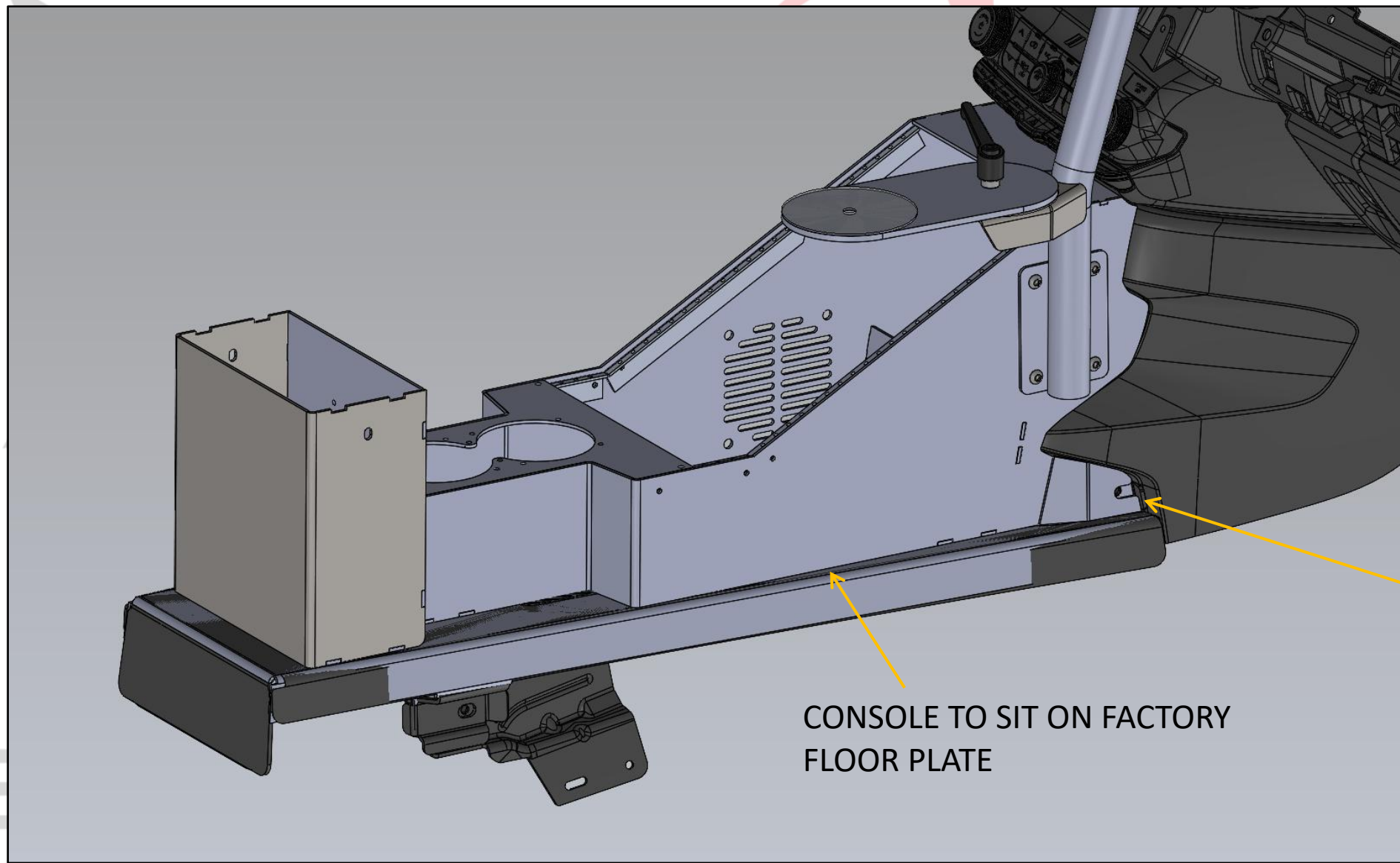

CONSOLE TO SIT ON FACTORY  
FLOOR PLATE

CONSOLE TO ATTACH AT  
FACTORY  
MOUNTING  
LOCATIONS X2  
(EACH SIDE)

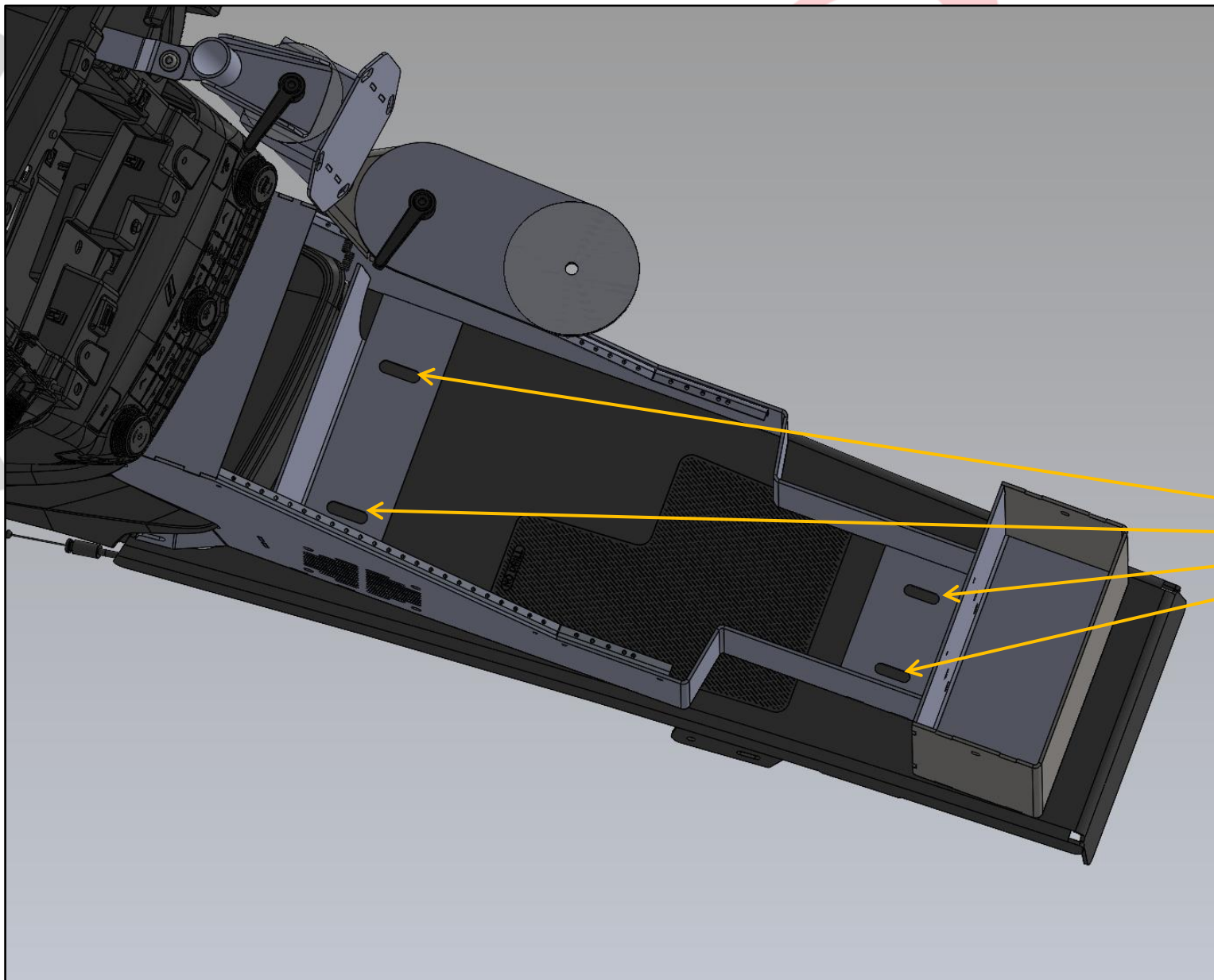

1. LOOSEN FACTORY SCREWS ON FRONT OF FLOOR PLATE
2. SET CONSOLE ON FACTORY FLOOR PLATE
3. MARK SLOT LOCATION ON FACTORY FLOOR PLATE
4. REMOVE CONSOLE, DRILL AND INSTALL PROVIDED NUTSERTS INTO FLOORPLATE
5. PLACE CONSOLE BACK ONTO FLOORPLATE AND ATTACH CONSOLE TO FLOORPLATE USING  $\frac{1}{4}$ -20 SCREWS AND WASHERS.
6. RE-INSTALL CUPHOLDER INTO CONSOLE.

UTILIZE PROVIDED NUTSERTS TO ATTACH CONSOLE TO FLOOR PLATE.

EQUIPMENT



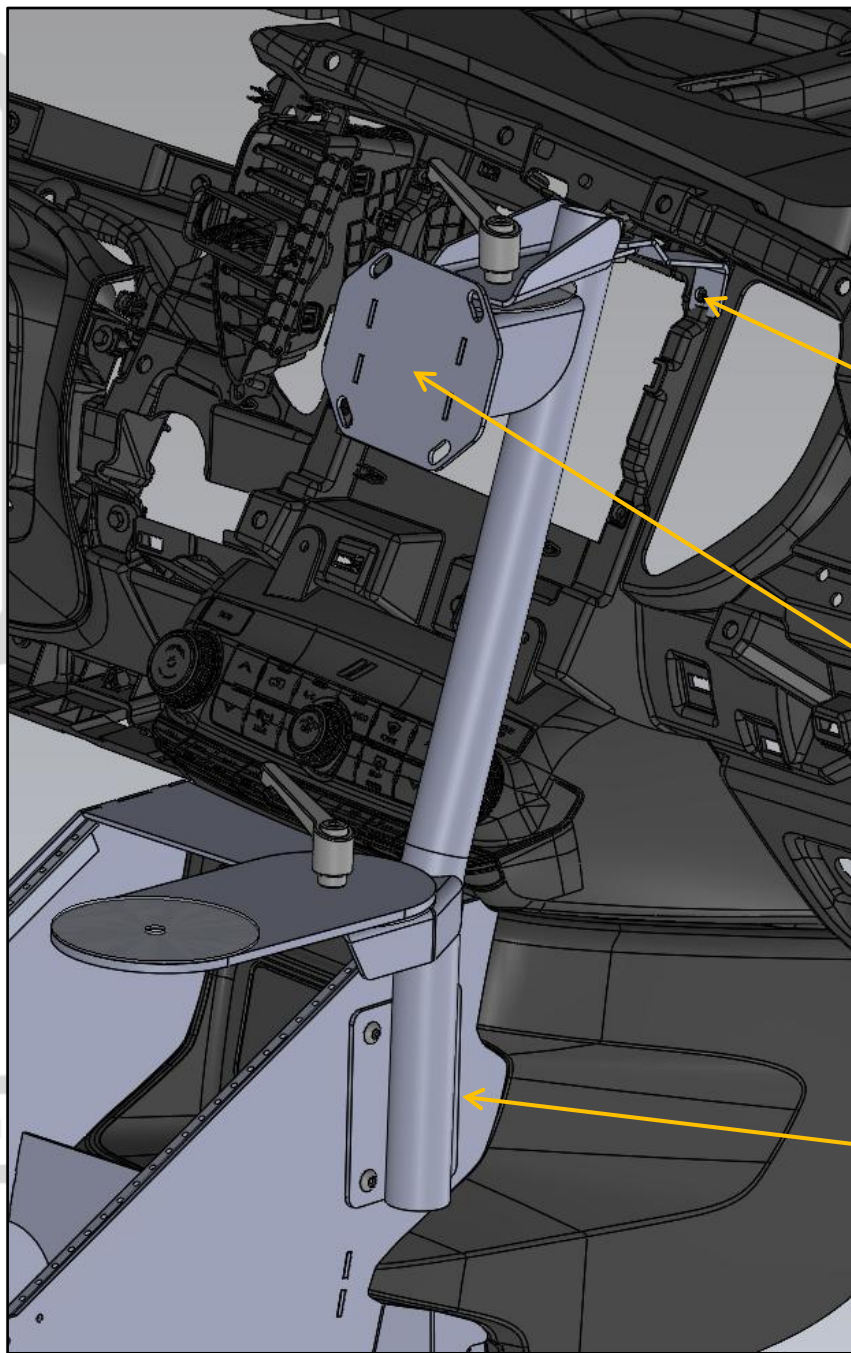

DASH BRACKET TO ATTACH UNDERNEATH CONSOLE TRIM. SURROUND MAY NEED TO BE TRIMED FOR BRACKET.

TABLET DOCK TO MOUNT TO UNIVERSAL COMPUTER MOUNT. USES STANDARD DOCK MOUNTING PATTERN.

BRACKET TO ATTACH TO CENTER CONSOLE USING 4X  $\frac{1}{4}$ -20 BHCS W/WASHERS.

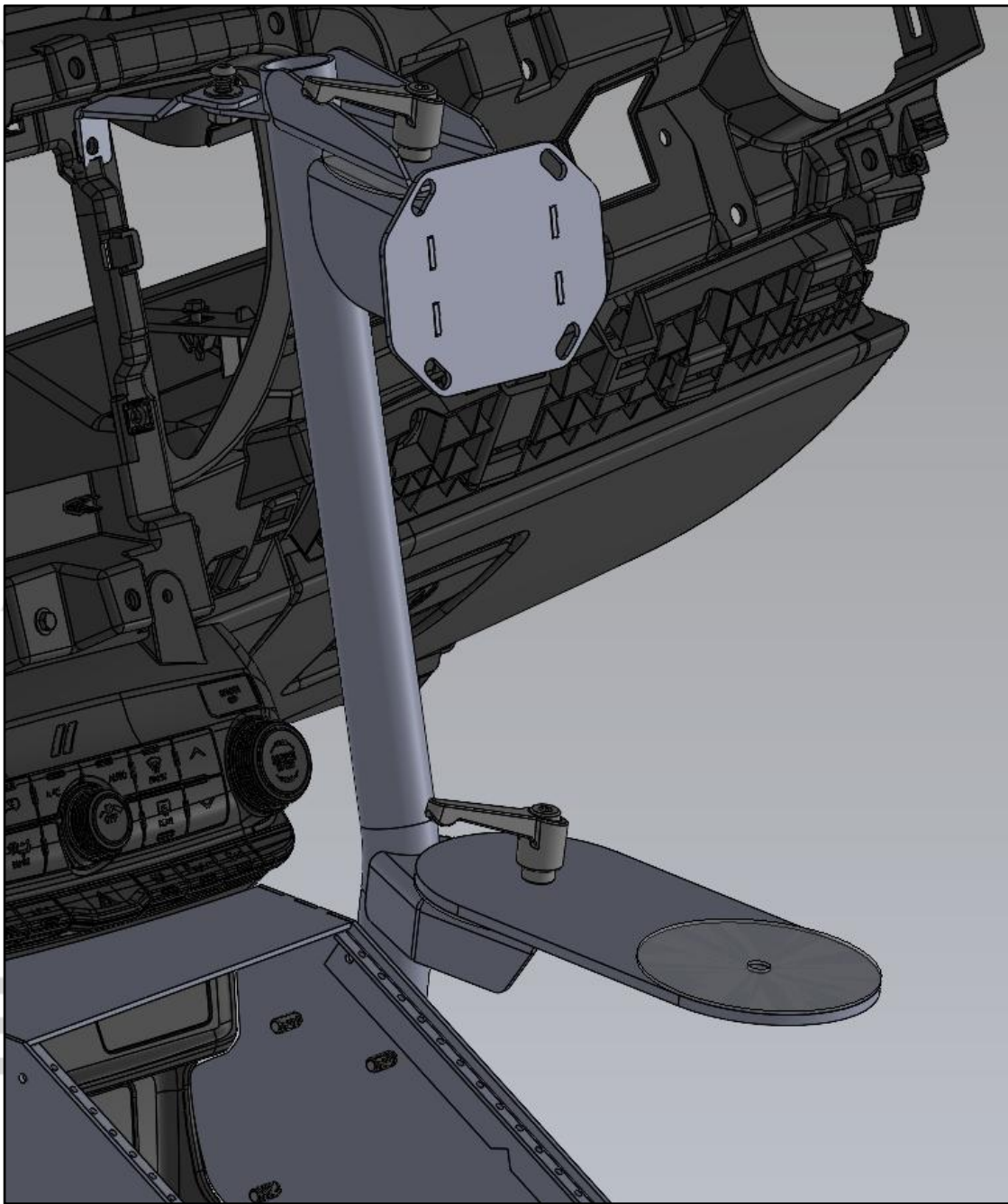

Y E





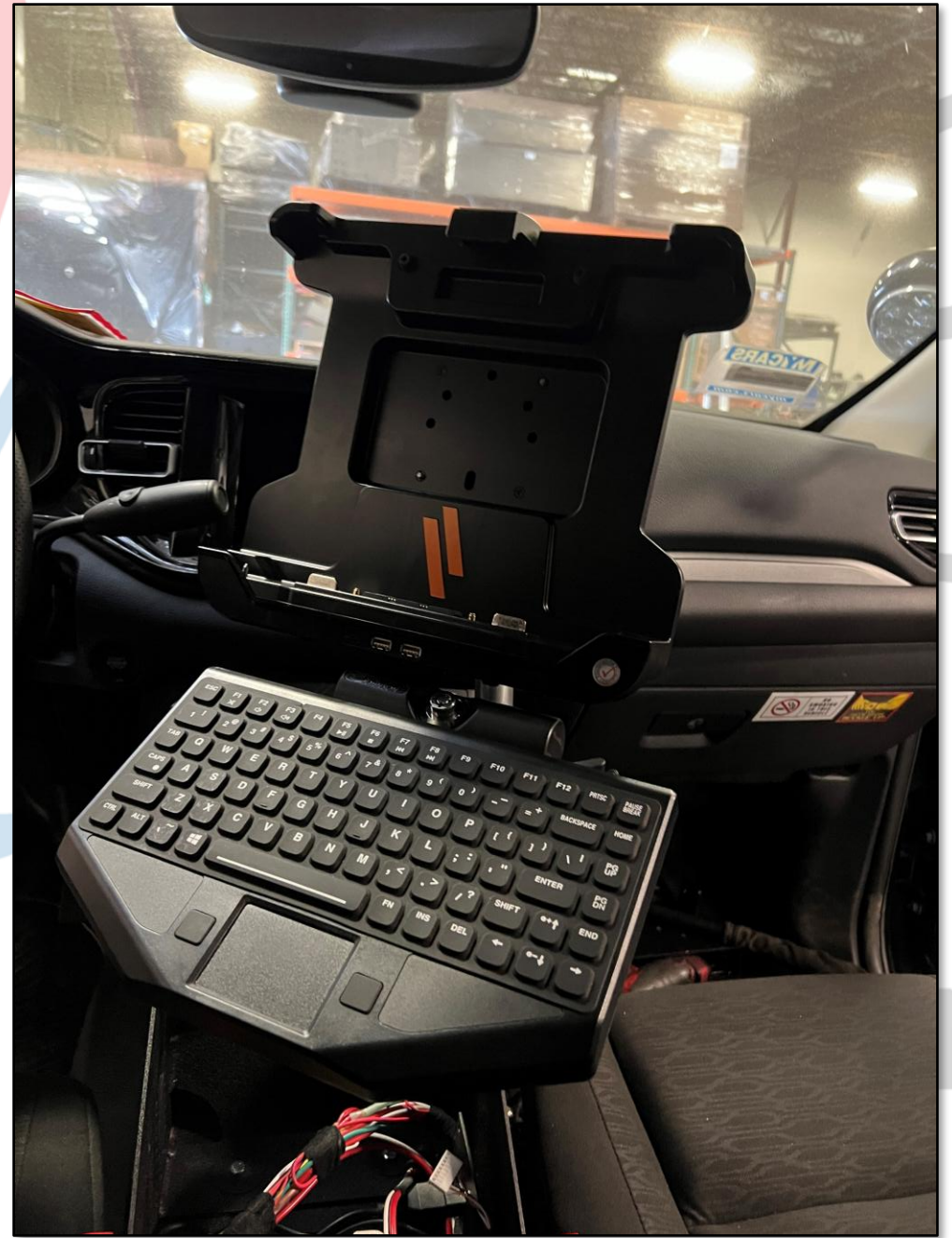





1616 MARLBOROUGH AVE. RIVERSIDE, CA 92507

FOR TECHNICAL ASSISTANCE WITH INSTALLATION OR  
OTHER QUESTIONS, PLEASE CALL (951) 222-2270

OR EMAIL [SUPPORT@IDSMP.COM](mailto:SUPPORT@IDSMP.COM)

*Thank you for your business!*