

EMERGENCY EQUIPMENT

INV-BOX-MK-TRAVERSE

INSTALLATION INSTRUCTIONS



## INSTALLATION OF REAR SLIDING BOX MOUNT

### INSTALL KIT INCLUDES:

- 2X MOUNTING FEET
- 2X SLIDE RAIL BRACKETS
- 1 SET LOCKING SLIDE RAILS
- 2X SUPPORT BRACKETS
- 4X 1-1/2" ¼-20 SHCS & WASHERS
- 2X ¾" 10-32 FHCS
- 4X #10 NUTS & WASHERS

EMERGENCY EQUIPMENT



CUT OUT REAR TUB

MARK AS SHOWN FOR CUTTING OUT  
REAR TUB TO RETAIN ACCESS TO  
SPARE TIRE





RE-INSTALL REMAINING TUB

INSTALL FEET  
AS PICTURED  
INSIDE TUB

#10 NUTS  
& WASHERS  
MOUNT TO  
EXISTING  
STUDS

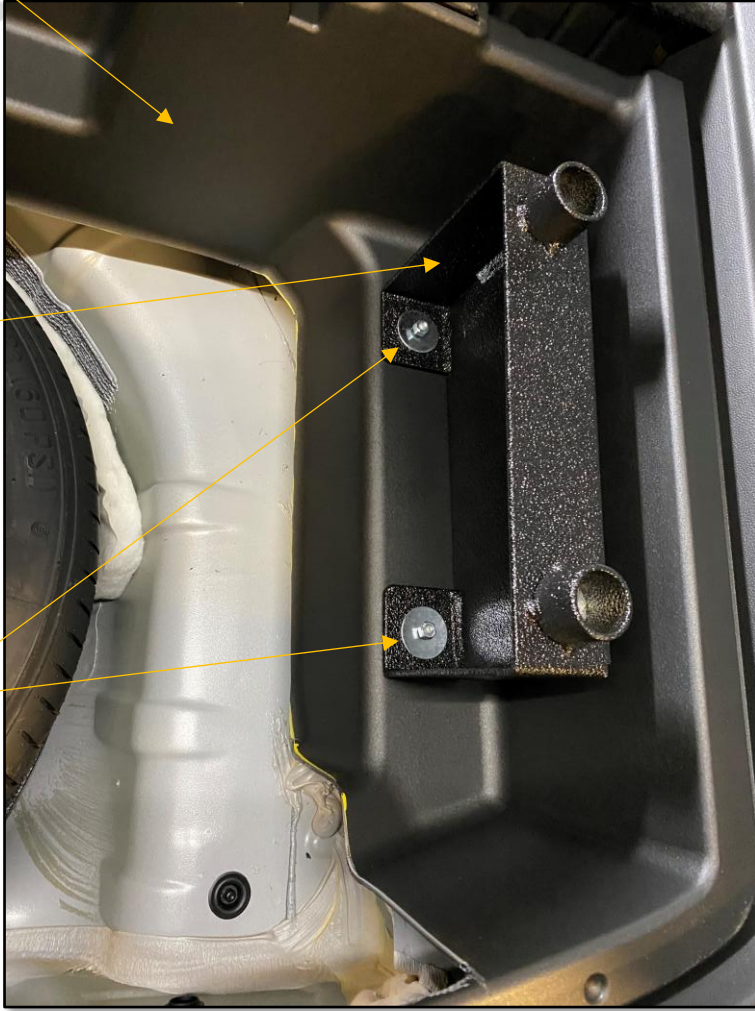

INSTALL LID AS SHOWN AND MARK FOR CUTTING,  
LOWER LID AND TAP LIGHTLY WITH HAMMER TO  
INDENT TAPE TO MARK FOR CUTTING HOLES.  
CUT WITH 1-1/2" HOLE SAW.

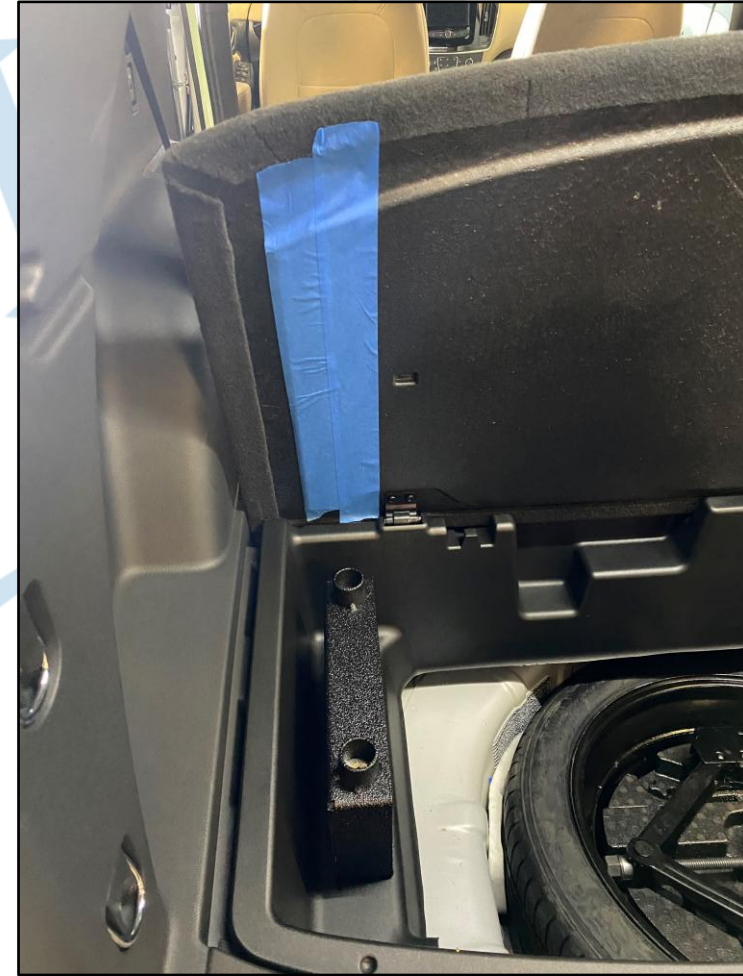

MARK LID 1" IN FROM HOLES AS SHOWN

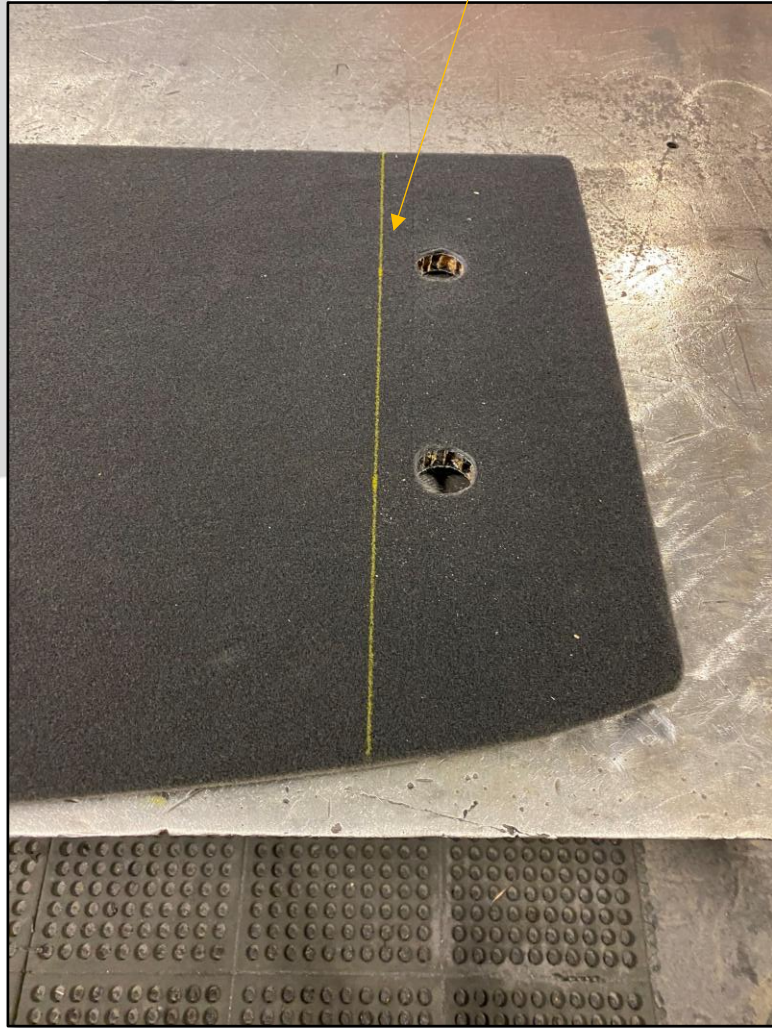

RE-INSTALL LID, REMOVE LID HINGES, AND  
CUT OUT CENTER FOR SPARE TIRE ACCESS  
LID WILL SIT ON FRONT AND BACK LEDGES





INSTALL SLIDE RAIL BRACKETS ON FEET AS SHOWN, NOTE ORIENTATION OF BRACKETS TO REAR OF VEHICLE

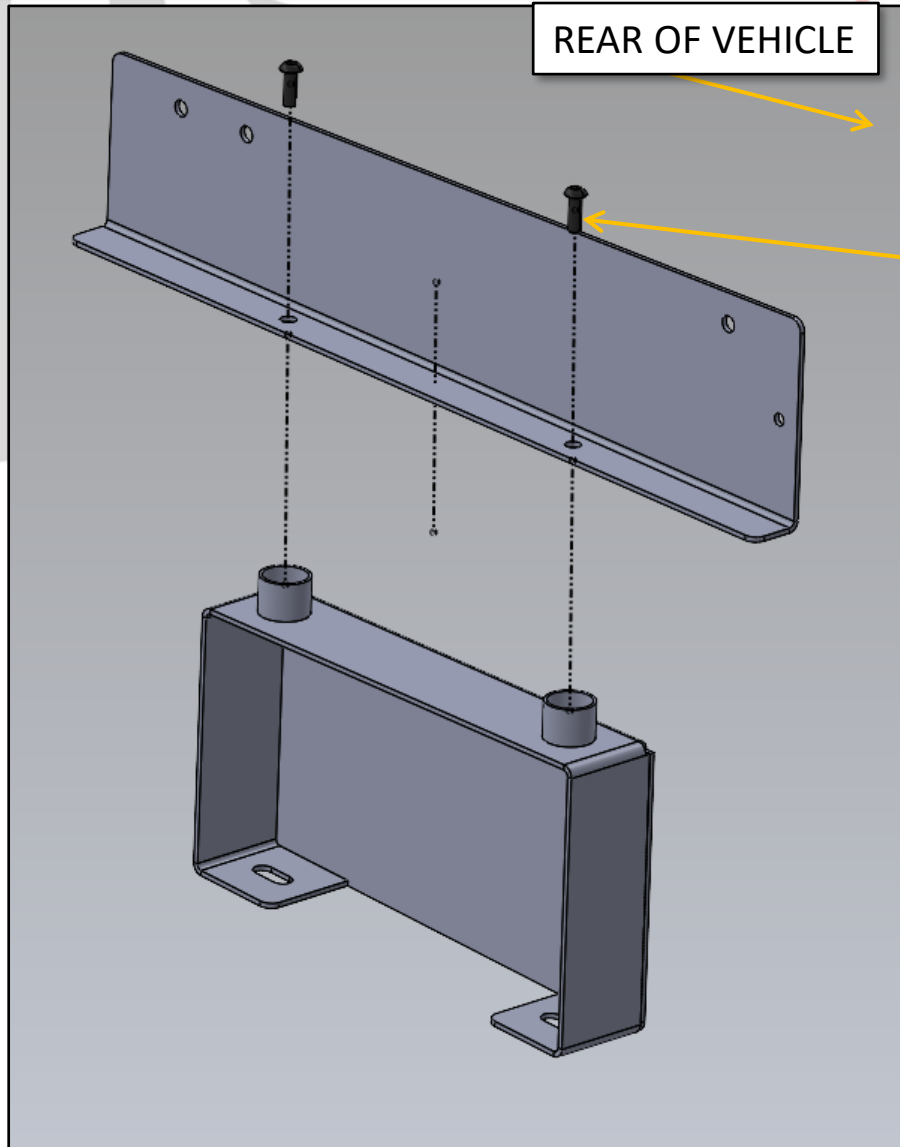

REAR OF VEHICLE

USE 1-1/2"  $\frac{1}{4}$  -20 BOLTS & WASHERS TO SECURE SLIDE RAIL BRACKETS

RE-USE HARDWARE FROM VEHICLE TO ATTACH SUPPORT BRACKETS

INSTALL BRACES AS SHOWN TO BRACKETS AND POINTS SHOWN ON VEHICLE

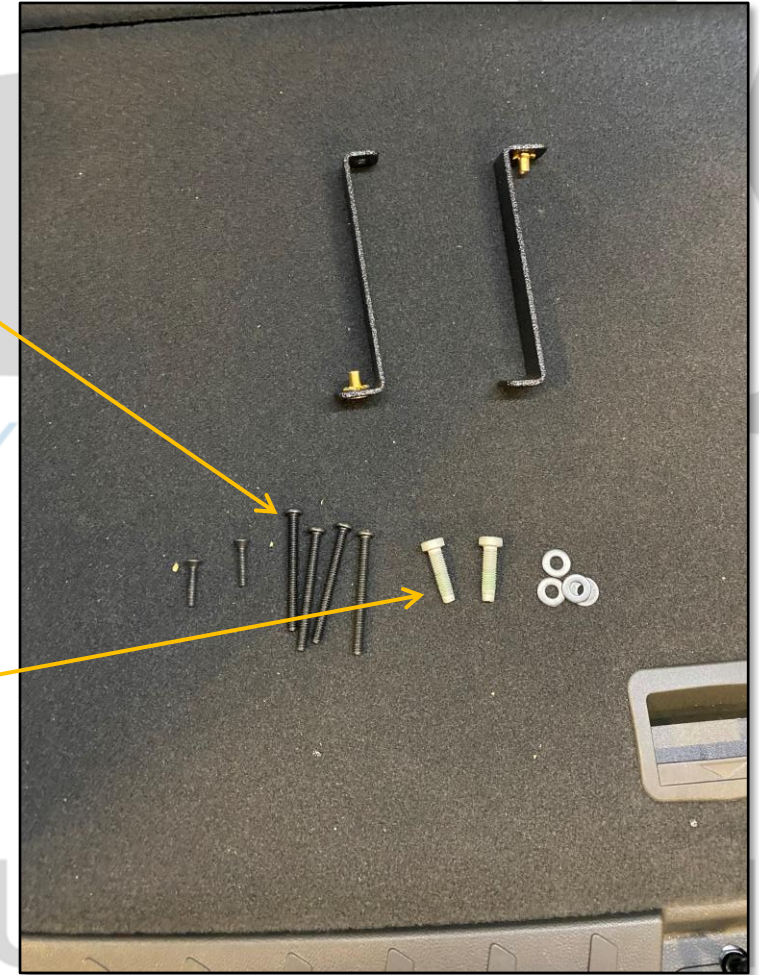

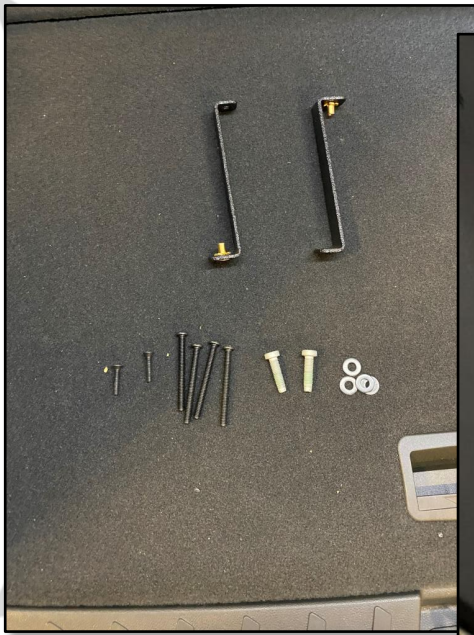

INSTALL BRACES AS SHOWN TO BRACKETS  
AND POINTS SHOWN ON VEHICLE



EXISTING VEHICLE HARDWARE  
IS RE-USED TO ATTACH  
BRACKETS AS SHOWN

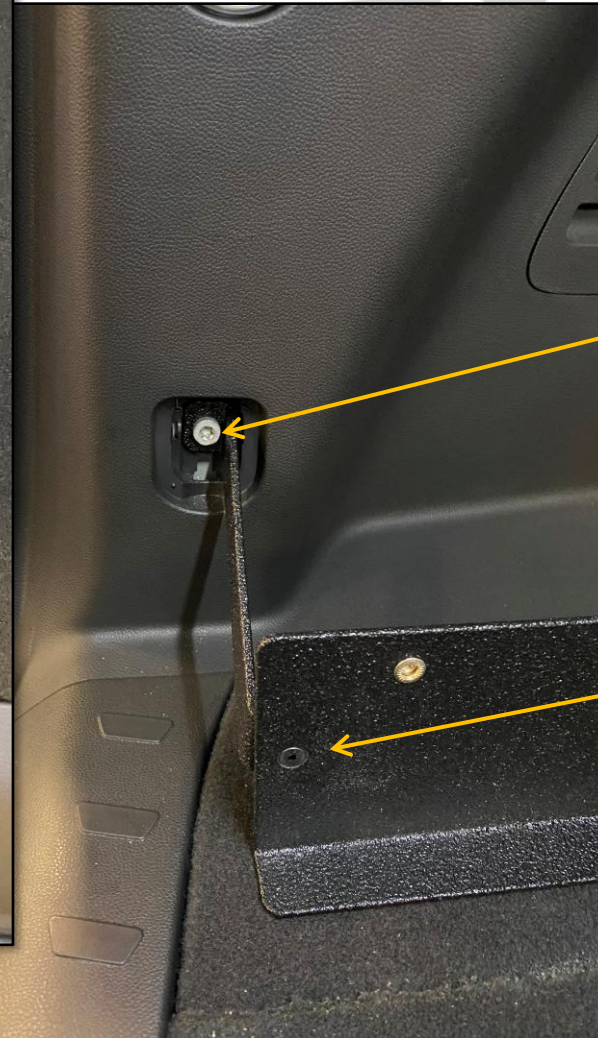

**IMPORTANT:**  
BE SURE TO USE  
FLAT HEAD SCREWS  
TO AVOID BINDING  
ON SLIDES



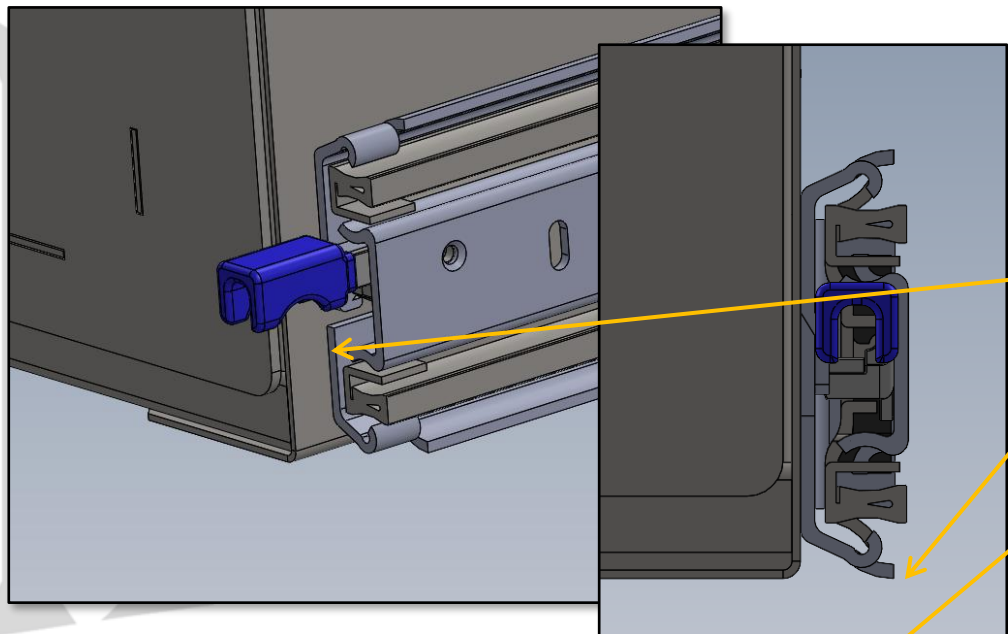

**NOTE:** IF BOX DOES NOT HAVE PRE-INSTALLED NUTSERTS YOU WILL NEED TO MARK AND DRILL HOLES AS FOLLOWS:

LINE SLIDE UP TO BOX AS SHOWN, APPROX 3/8" TO 1/2" FROM FRONT EDGE, AND LEVEL WITH BOTTOM EDGE.

OPEN SLIDE ENOUGH TO SEE FORWARD MOST MOUNTING HOLE.

USING SLIDE HOLES SHOWN, MARK AND DRILL FOR HARDWARE INSTALLATION.

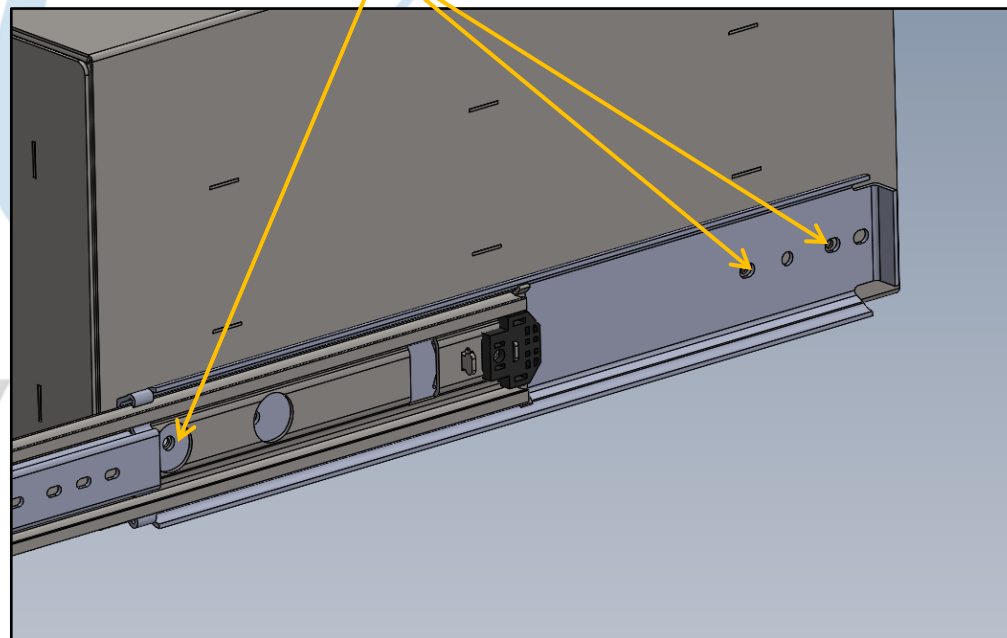
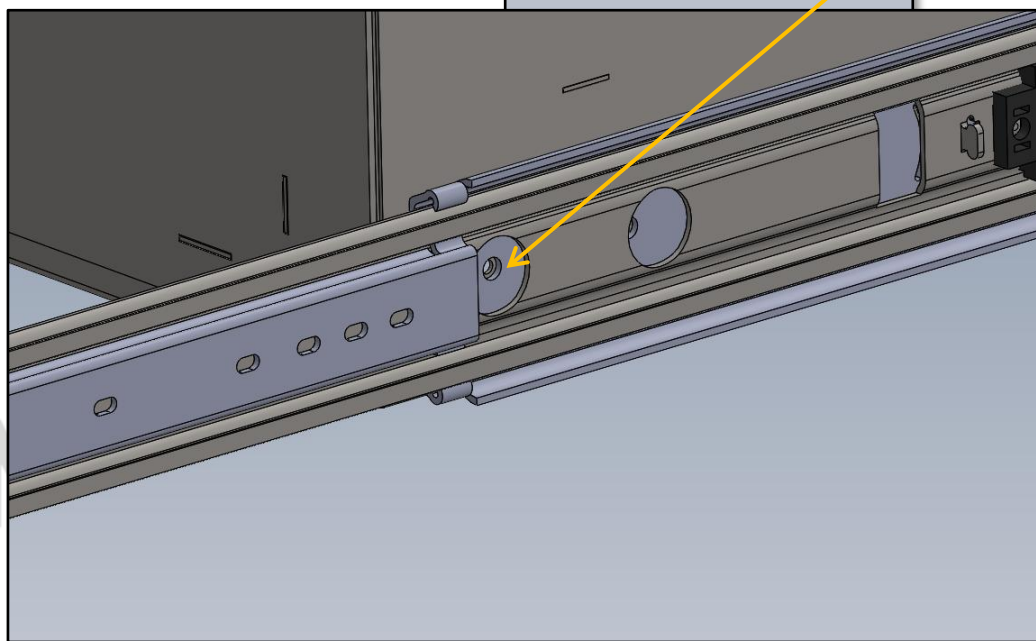



INSTALL LOCKING SLIDES TO BRACKETS,  
AND MOUNT BOX TO SLIDES

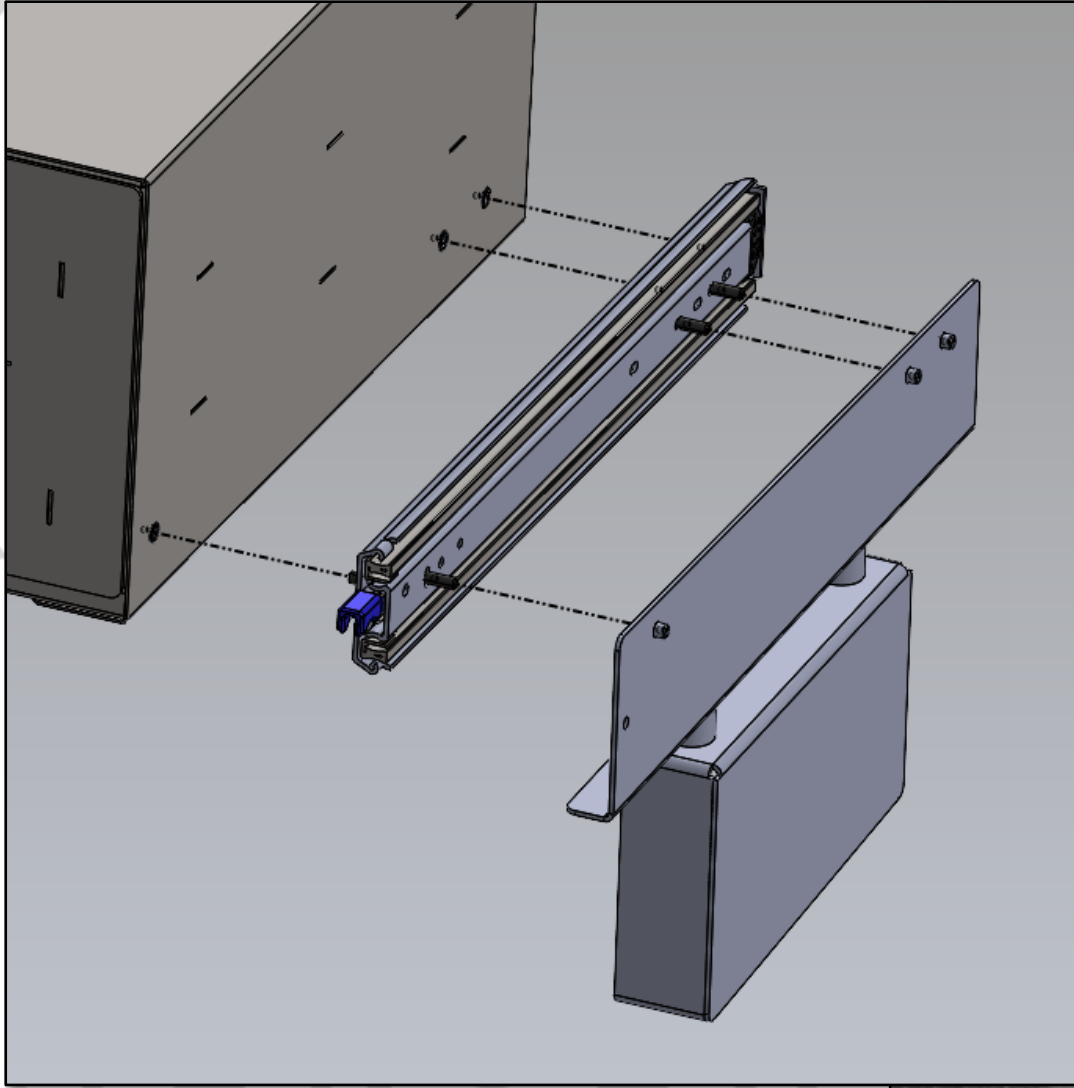







1616 MARLBOROUGH AVE. RIVERSIDE, CA 92507

FOR TECHNICAL ASSISTANCE WITH INSTALLATION OR  
OTHER QUESTIONS, PLEASE CALL (951) 222-2270

OR EMAIL [SUPPORT@IDSMP.COM](mailto:SUPPORT@IDSMP.COM)

*Thank you for your business!*