

EMERGENCY EQUIPMENT

INV-BOX-MK-TRAVERSE

INSTALLATION INSTRUCTIONS



INSTALLATION OF REAR SLIDING BOX MOUNT

INSTALL KIT INCLUDES:

- 2X MOUNTING FEET
- 2X SLIDE RAIL BRACKETS
- 1 SET LOCKING SLIDE RAILS
- 2X SUPPORT BRACKETS
- 4X 1-1/2" ¼-20 SHCS & WASHERS
- 2X ¾" 10-32 FHCS
- 4X #10 NUTS & WASHERS

EMERGENCY EQUIPMENT



CUT OUT REAR TUB

MARK AS SHOWN FOR CUTTING OUT
REAR TUB TO RETAIN ACCESS TO
SPARE TIRE



RE-INSTALL REMAINING TUB

INSTALL FEET
AS PICTURED
INSIDE TUB

#10 NUTS
& WASHERS
MOUNT TO
EXISTING
STUDS



INSTALL LID AS SHOWN AND MARK FOR CUTTING,
LOWER LID AND TAP LIGHTLY WITH HAMMER TO
INDENT TAPE TO MARK FOR CUTTING HOLES.
CUT WITH 1-1/2" HOLE SAW.

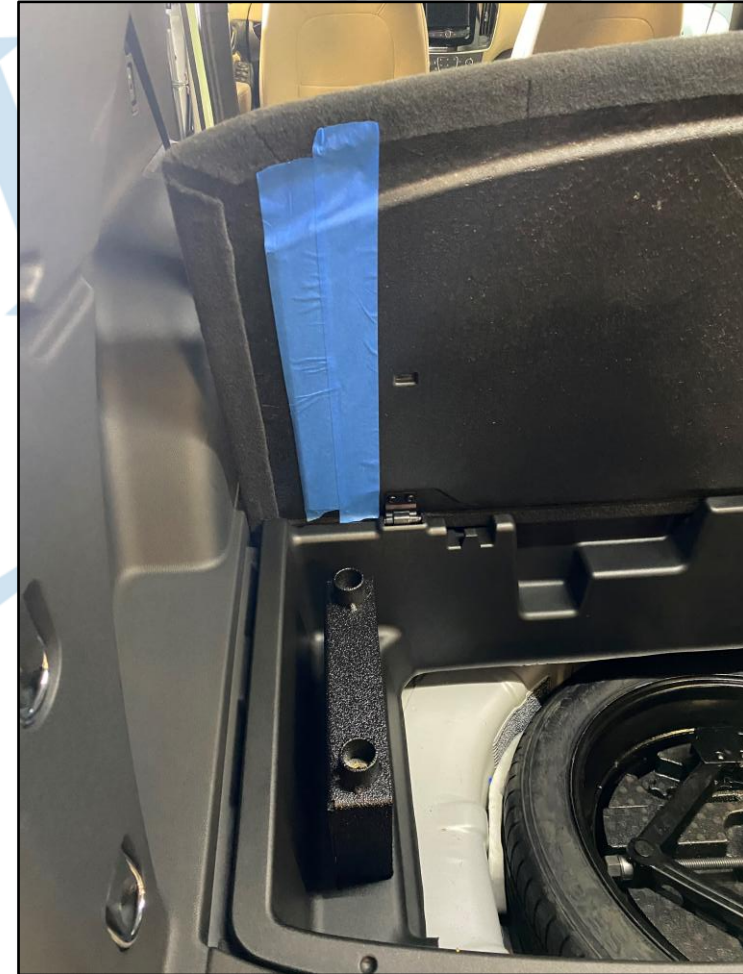

MARK LID 1" IN FROM HOLES AS SHOWN

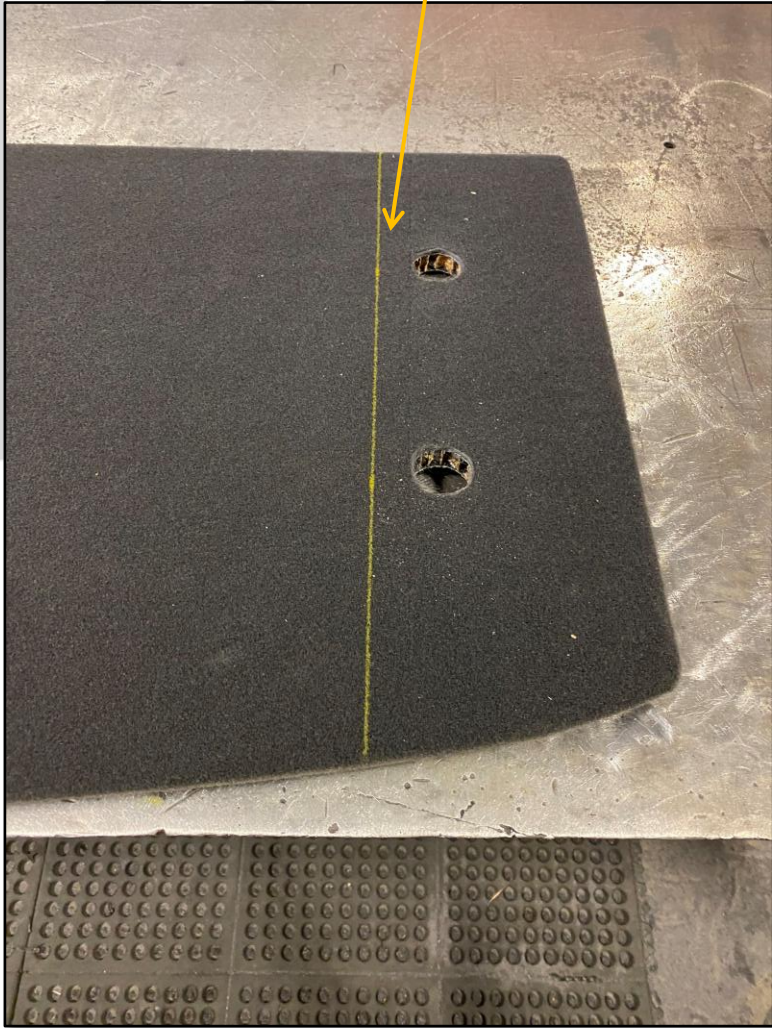

RE-INSTALL LID, REMOVE LID HINGES, AND
CUT OUT CENTER FOR SPARE TIRE ACCESS
LID WILL SIT ON FRONT AND BACK LEDGES



INSTALL SLIDE RAIL BRACKETS ON FEET AS SHOWN, NOTE ORIENTATION OF BRACKETS TO REAR OF VEHICLE

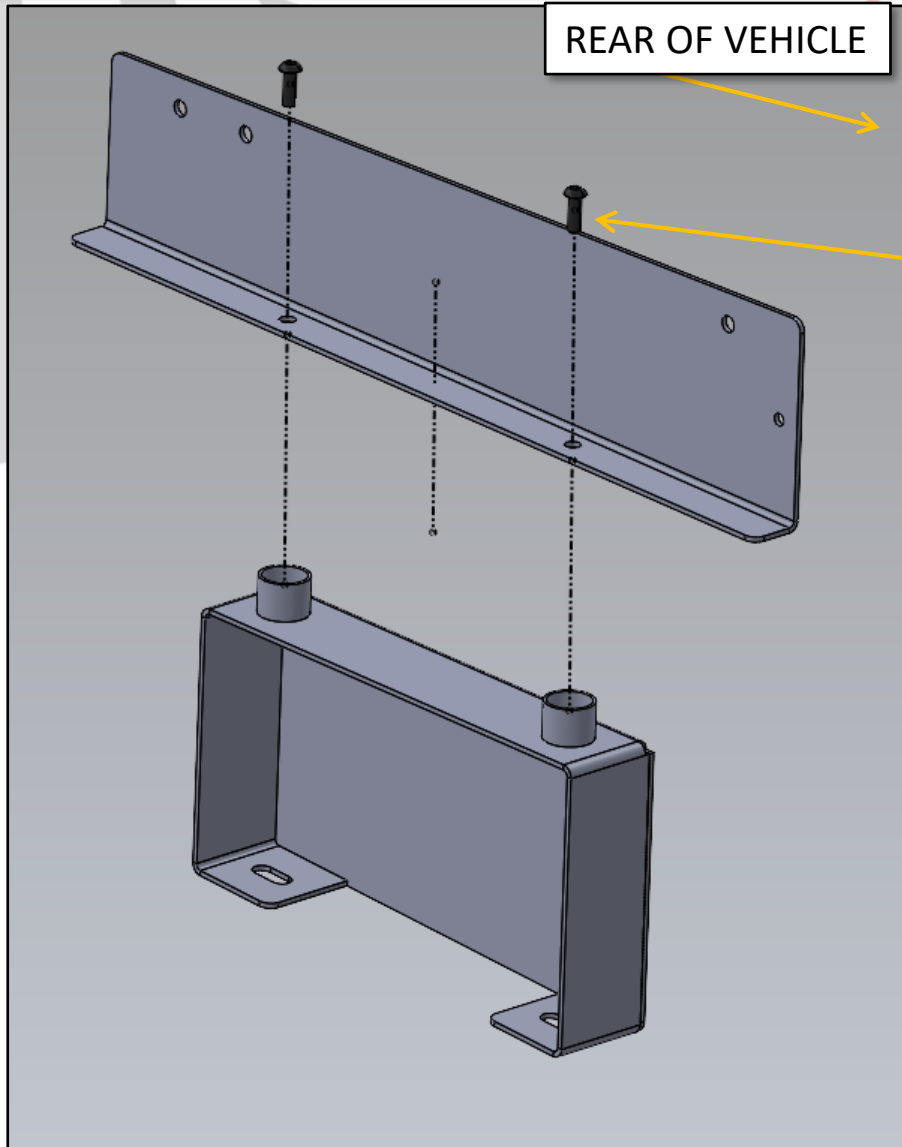

USE 1-1/2" $\frac{1}{4}$ -20 BOLTS & WASHERS TO SECURE SLIDE RAIL BRACKETS

RE-USE HARDWARE FROM VEHICLE TO ATTACH SUPPORT BRACKETS

INSTALL BRACES AS SHOWN TO BRACKETS AND POINTS SHOWN ON VEHICLE

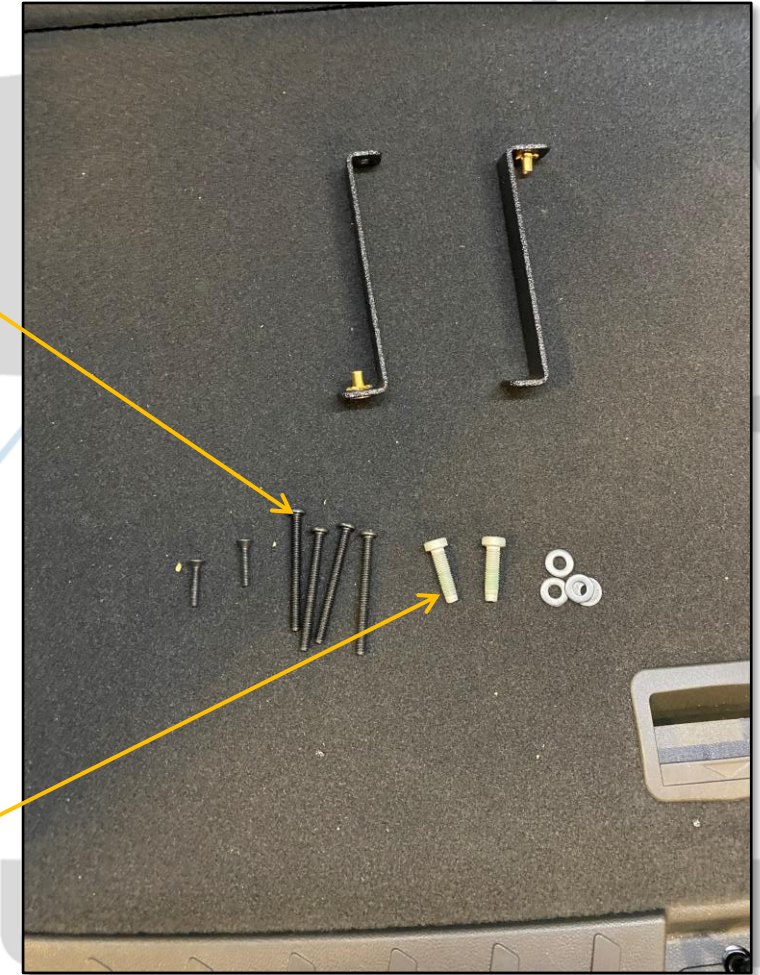



INSTALL BRACES AS SHOWN TO BRACKETS
AND POINTS SHOWN ON VEHICLE



EXISTING VEHICLE HARDWARE
IS RE-USED TO ATTACH
BRACKETS AS SHOWN

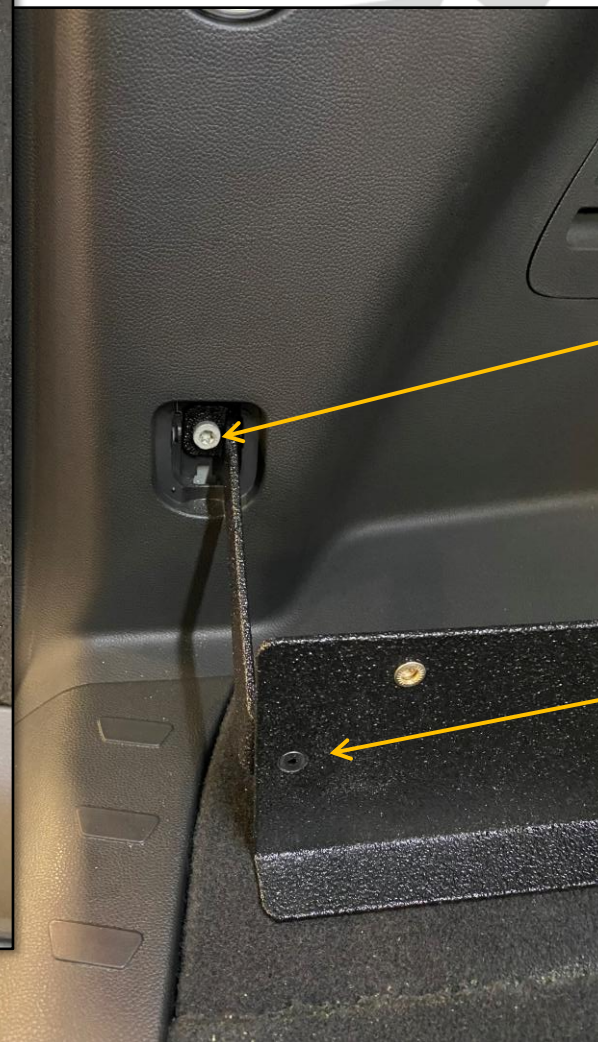

IMPORTANT:
BE SURE TO USE
FLAT HEAD SCREWS
TO AVOID BINDING
ON SLIDES

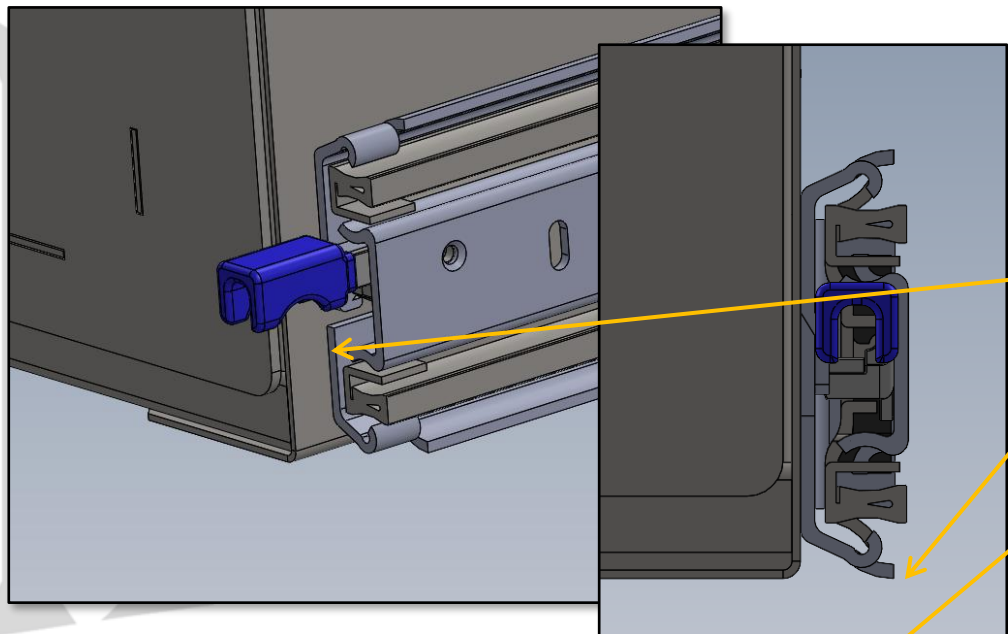

NOTE: IF BOX DOES NOT HAVE PRE-INSTALLED NUTSERTS YOU WILL NEED TO MARK AND DRILL HOLES AS FOLLOWS:

LINE SLIDE UP TO BOX AS SHOWN, APPROX 3/8" TO 1/2" FROM FRONT EDGE, AND LEVEL WITH BOTTOM EDGE.

OPEN SLIDE ENOUGH TO SEE FORWARD MOST MOUNTING HOLE.

USING SLIDE HOLES SHOWN, MARK AND DRILL FOR HARDWARE INSTALLATION.

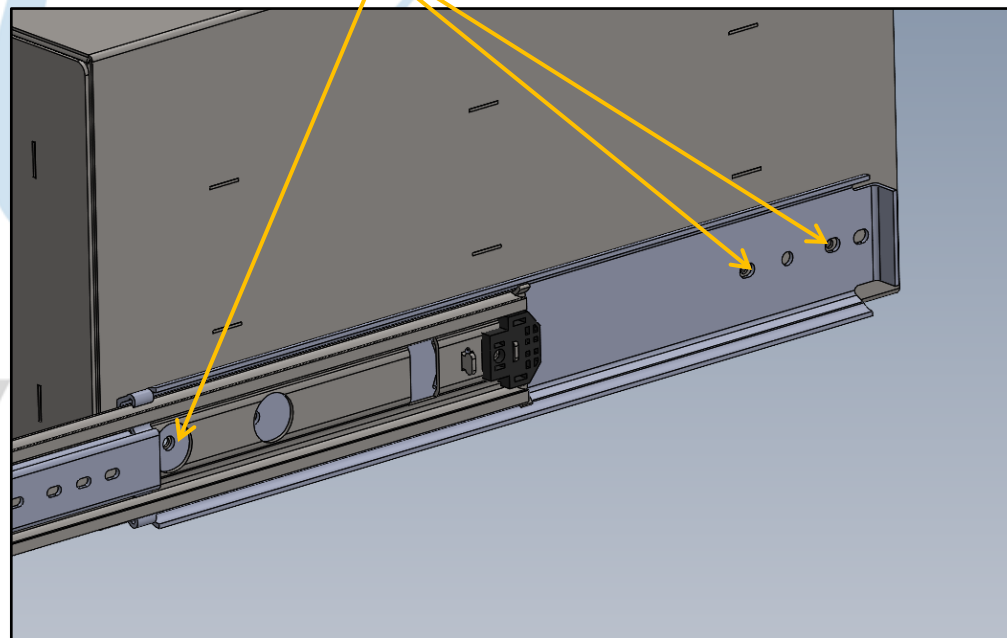
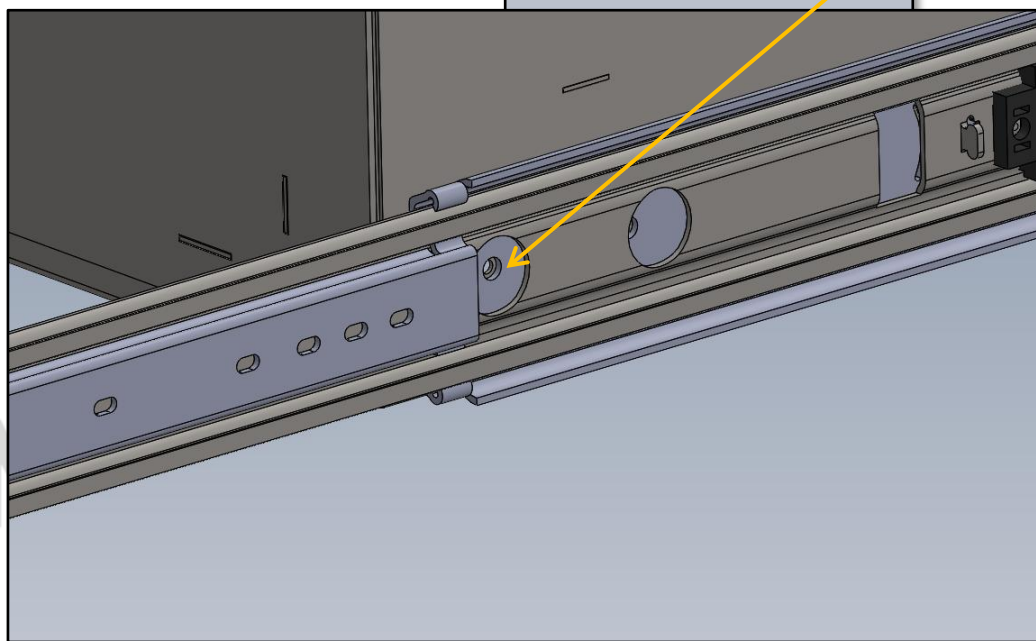

INSTALL LOCKING SLIDES TO BRACKETS,
AND MOUNT BOX TO SLIDES

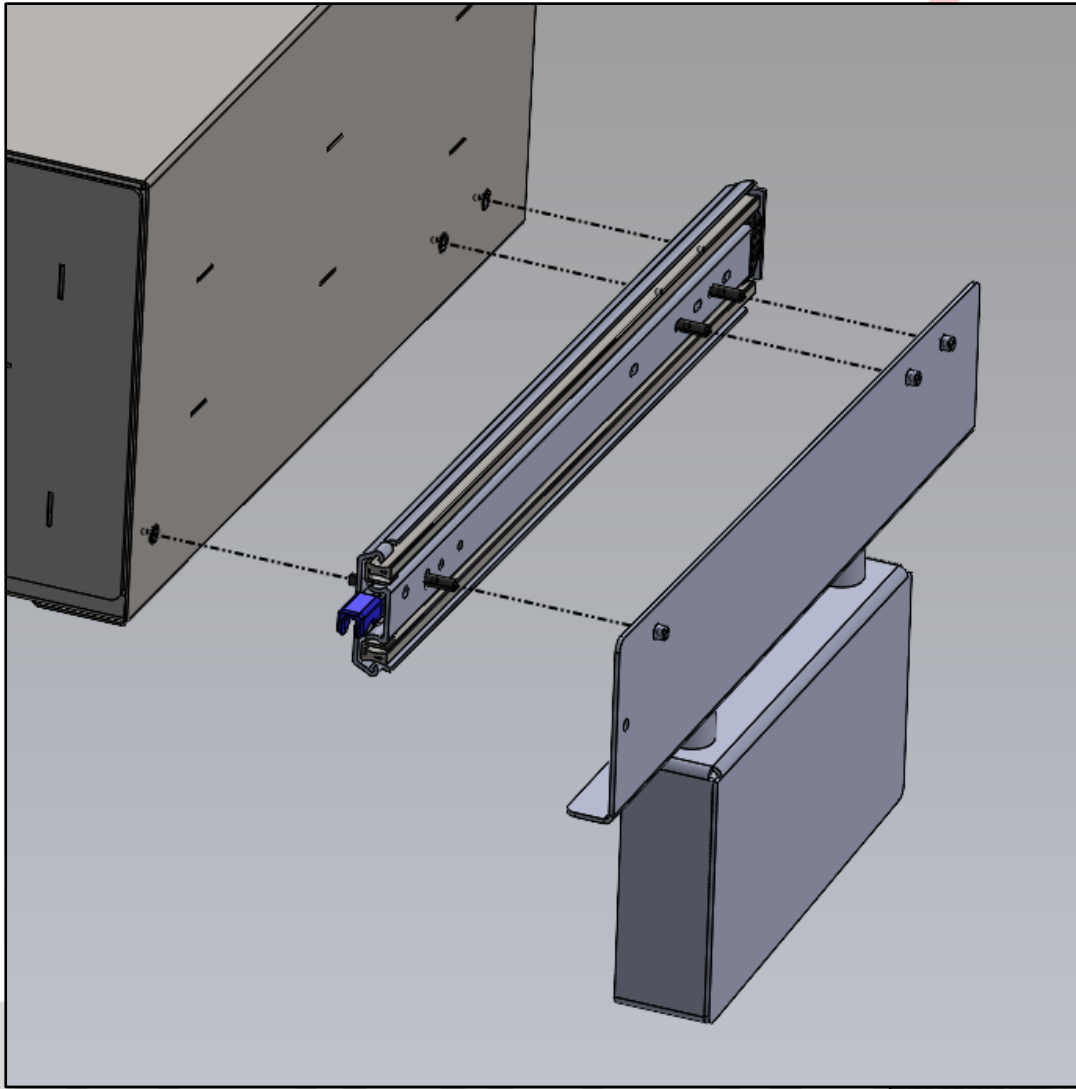



INSTALLATION COMPLETE





1616 MARLBOROUGH AVE. RIVERSIDE, CA 92507

FOR TECHNICAL ASSISTANCE WITH INSTALLATION OR
OTHER QUESTIONS, PLEASE CALL (951) 222-2270

OR EMAIL SUPPORT@IDSMP.COM

Thank you for your business!