

EMERGENCY EQUIPMENT

INV-CON-DN-PIU20-FFP

INSTALLATION INSTRUCTIONS

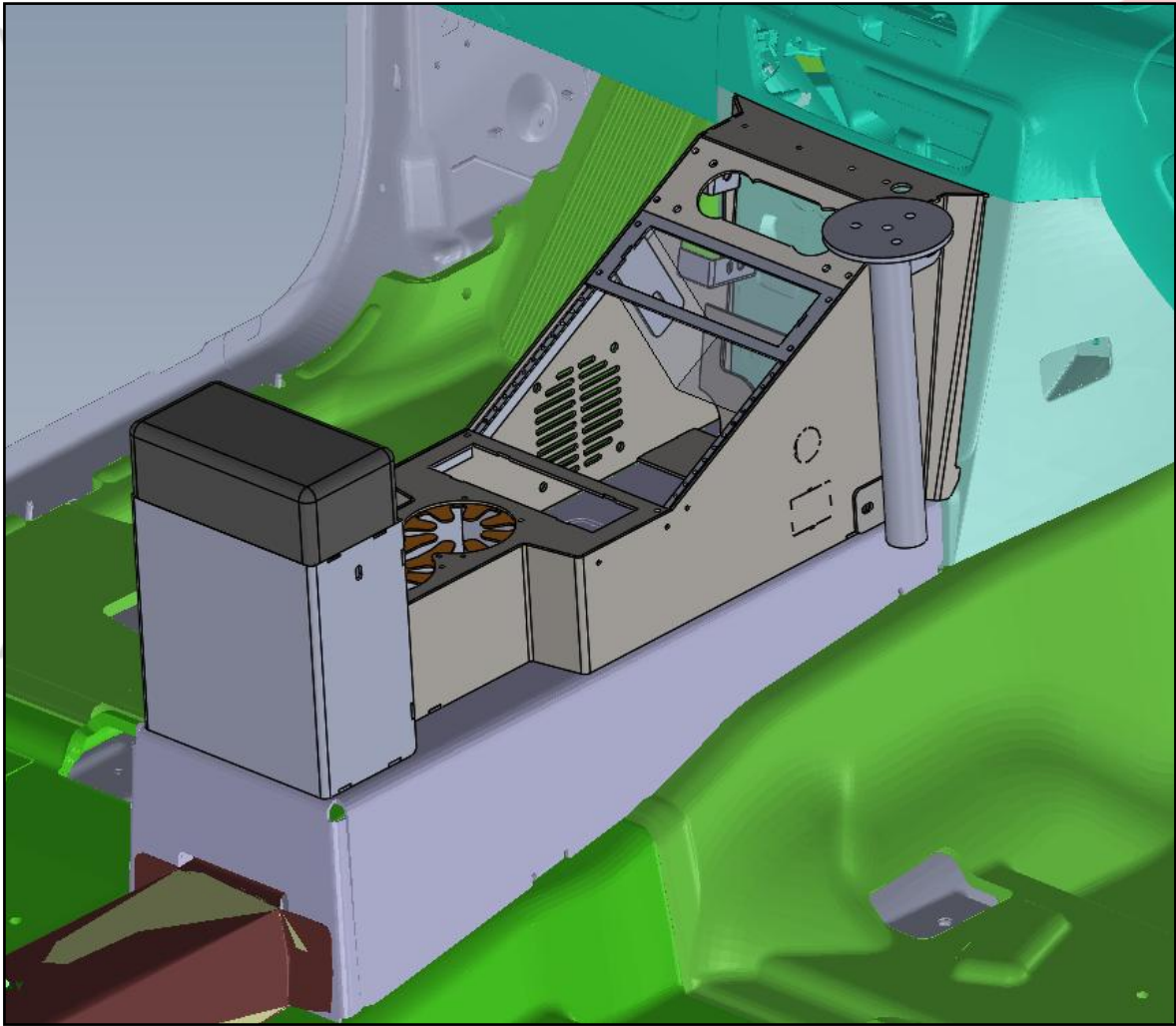

## INSTALLATION OF DUAL NOTCH CONSOLE WITH FACTORY FLOOR PLATE

### INSTALL KIT INCLUDES:

CONSOLE

ARMREST

LAPTOP MOUNT (IF ORDERED)

4X ¼-20 NUTSERTS

4X ¼-20 X ¾" SHCS

4X ¼" WASHERS

4X 10-32 NUTSERTS

4X 10-32 X ½" SHCS

4X 10-32 WASHERS

OTHER HARDWARE AS NEEDED PER ORDER

EMERGENCY EQUIPMENT



REMOVE FACTORY FLOOR PLATE AS SHOWN

REMOVE FACTORY FACEPLATE AS SHOWN.  
UNPLUG ALL SWITCHES, REMOVE AND RETAIN  
THEM FOR RE-INSTALL INTO THE CONSOLE.







INSTALL A/C CONTROLS IN PROVIDED FACEPLATE USING PROVIDED SPACERS AND HARDWARE.

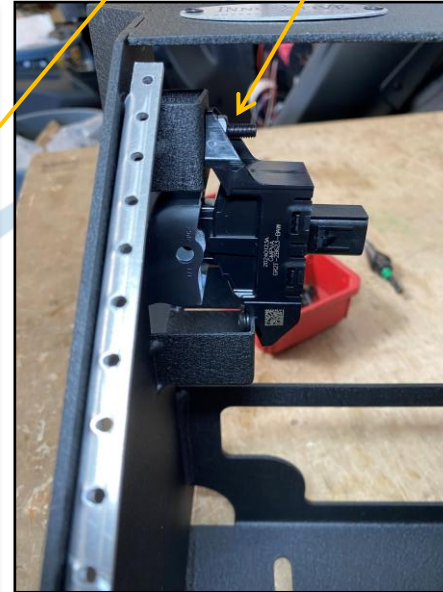
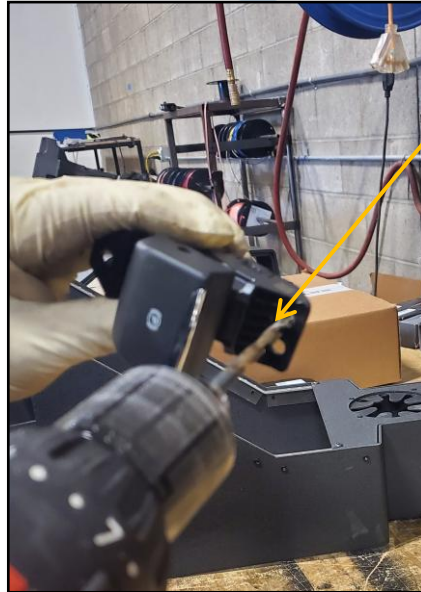

INSTALL PARKING BRAKE SWITCH:  
DRILL OUT MOUNTING HOLES SHOWN TO 3/16"  
ATTACH SWITCH TO BRACKET SHOWN WITH INCLUDED HARDWARE.



**OPTIONAL:**

INSTALL 12V RECEPTACLE AND USB PORTS, REMOVE KNOCK-OUTS ON SIDE OF CONSOLE INSTALL PORTS IN CORRESPONDING HOLES AS SHOWN



CUT WIRE ACCESS HOLE IN FACTORY FLOOR PLATE AS SHOWN (OPTIONAL). RE-INSTALL FACTORY FLOOR PLATE. PLACE CONSOLE IN POSITION, MARK AND DRILL FLOOR PLATE FOR PROVIDED ¼-20 NUTSERTS. INSTALL NUTSERTS.

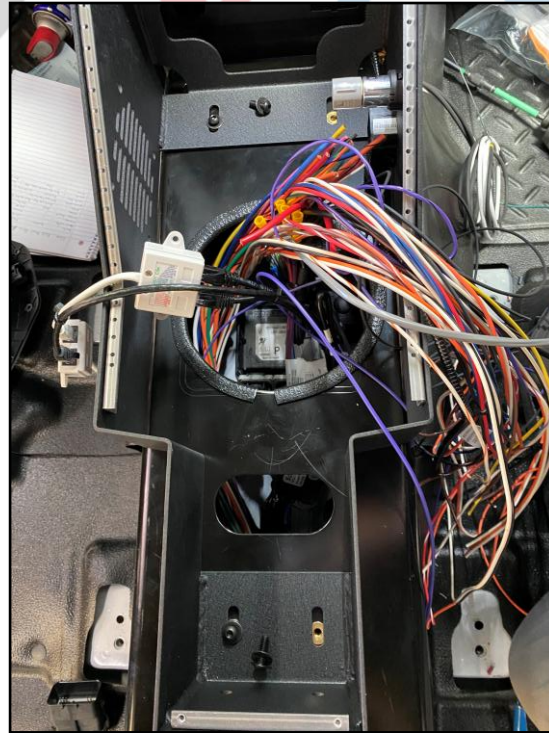

INSTALL CONSOLE ON FLOOR PLATE, SECURE WITH PROVIDED HARDWARE.

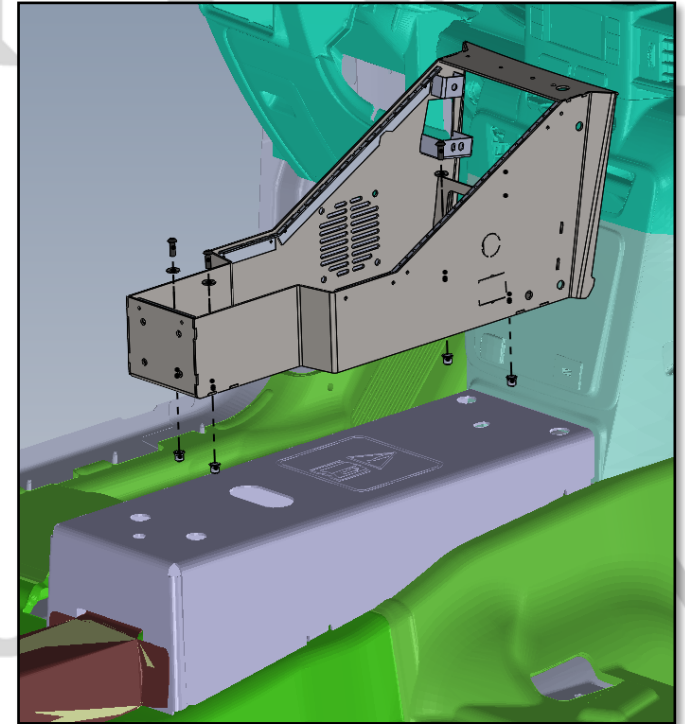



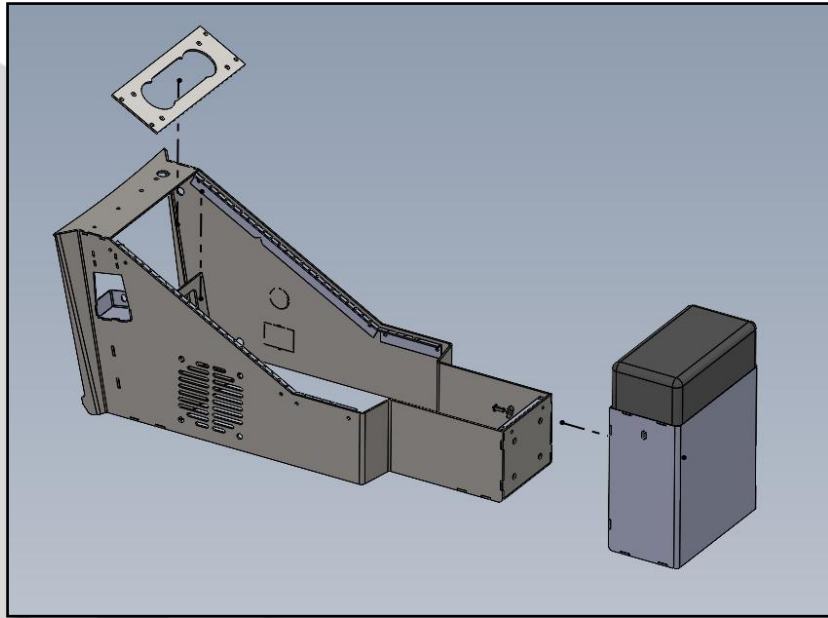

INSTALL A/C FACEPLATE AND  
MOUNT ARMREST USING  
PROVIDED HARDWARE.  
INSTALL CUPHOLDER/TRAY UNIT  
AND SECURE TO RAILS WITH  
PROVIDED HARDWARE.

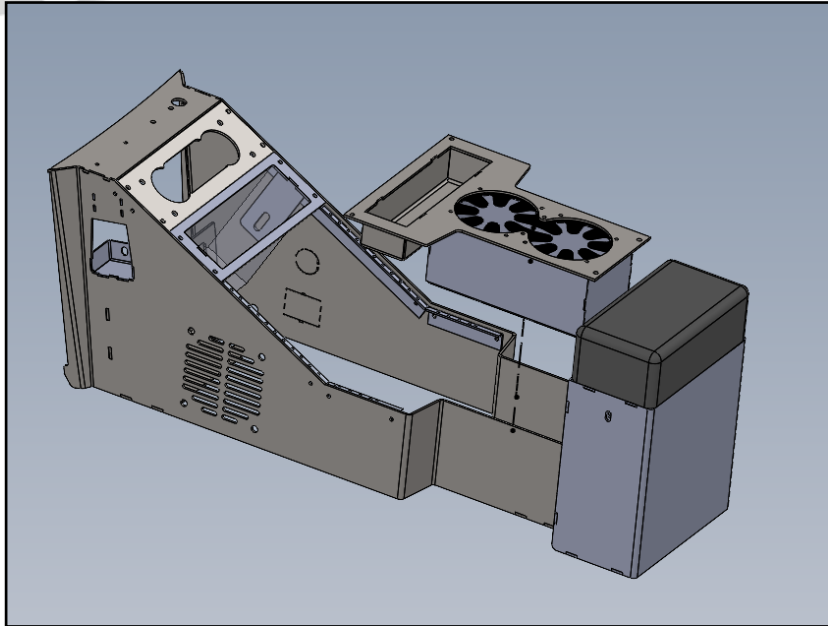

OPTIONAL: INSTALL  
LAPTOP MOUNT USING  
PROVIDED NUTSERTS  
AND HARDWARE TO  
EXISTING HOLES IN  
CONSOLE.

COMPLETE INSTALL WITH  
ADDITIONAL FACEPLATES  
AND RADIO UNITS PER  
CUSTOMER ORDER.

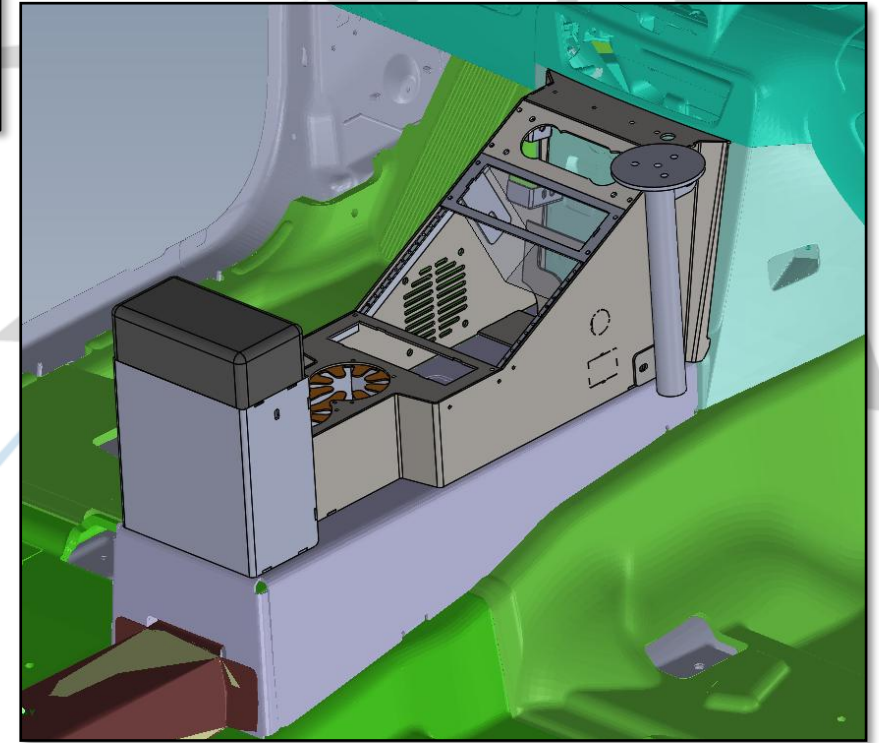



1616 MARLBOROUGH AVE. RIVERSIDE, CA 92507

FOR TECHNICAL ASSISTANCE WITH INSTALLATION OR  
OTHER QUESTIONS, PLEASE CALL (951) 222-2270

OR EMAIL [SUPPORT@IDSMP.COM](mailto:SUPPORT@IDSMP.COM)

*Thank you for your business!*