

EMERGENCY EQUIPMENT

INV-CON-WDB-EXPO

INSTALLATION INSTRUCTIONS

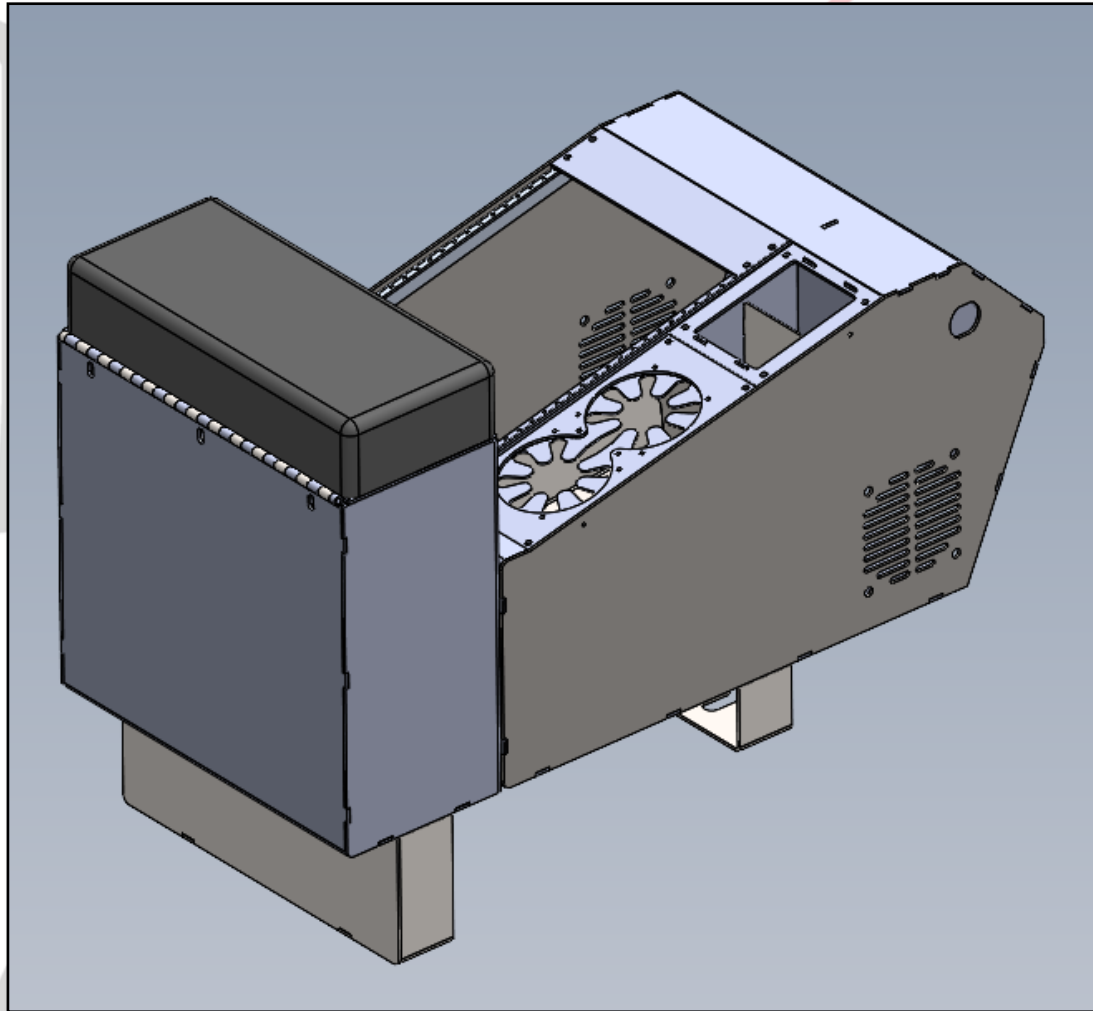

INSTALLATION OF CONSOLE WITH MOUNTING FEET

INSTALL KIT INCLUDES:

MOUNTING FEET
CONSOLE, CUPHOLDER, AND
ARMREST ASSEMBLY
4X $\frac{1}{4}$ -20 X $\frac{1}{2}$ " SCREWS
4X $\frac{1}{4}$ " WASHERS



START BY REMOVING THE FACTORY CONSOLE
BY REMOVING THE SCREWS AS SHOWN.
CONTINUE BY LOOSENING THE MODULE AND
REMOVING THE BRACKETS AS SHOWN.

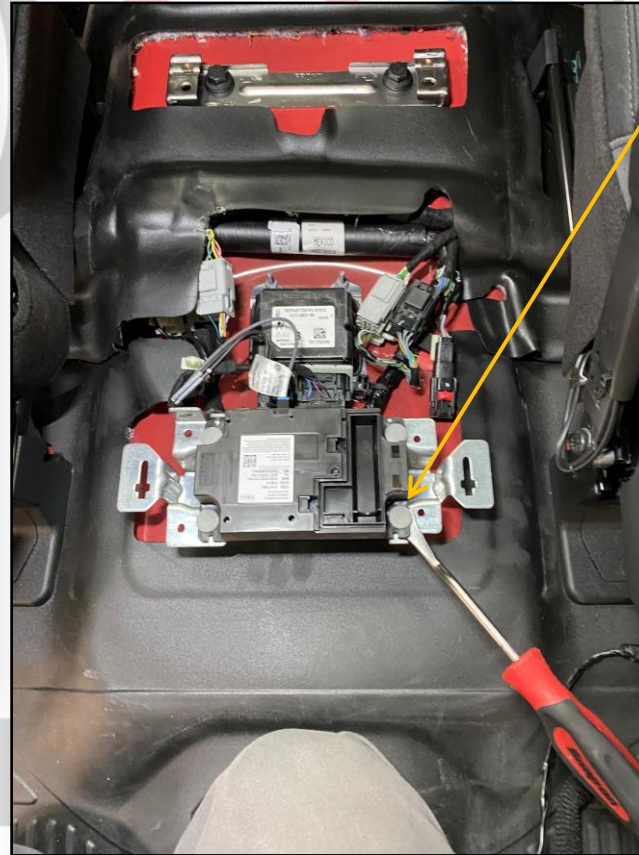

LOOSEN FACTORY BOLTS ENOUGH TO SLIDE MOUNTING FEET UNDER, MAKE SURE ARROWS ON MOUNTING FEET POINT TOWARDS FRONT OF VEHICLE.
TIGHTEN FACTORY BOLTS TO SECURE FEET.

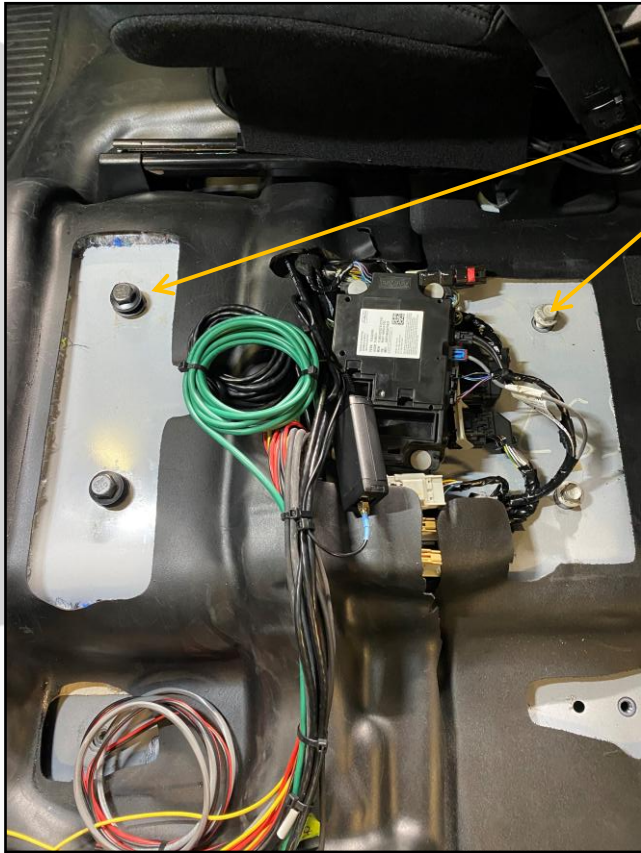

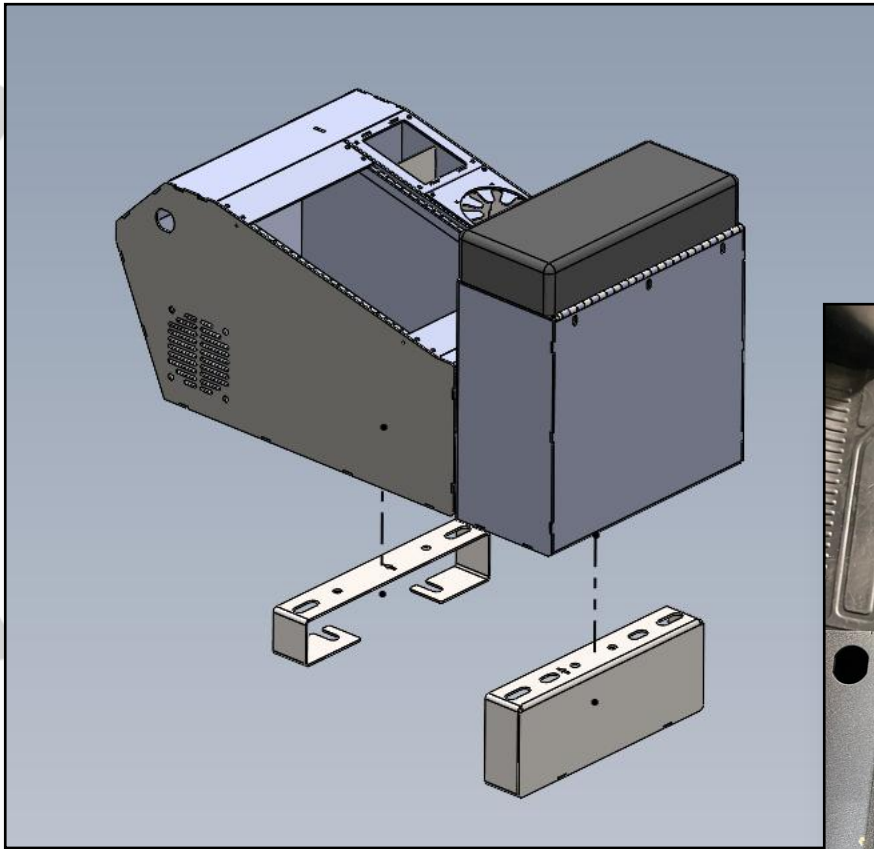

ATTACH CONSOLE TO FEET AND
SECURE AS SHOWN USING
SUPPLIED HARDWARE.

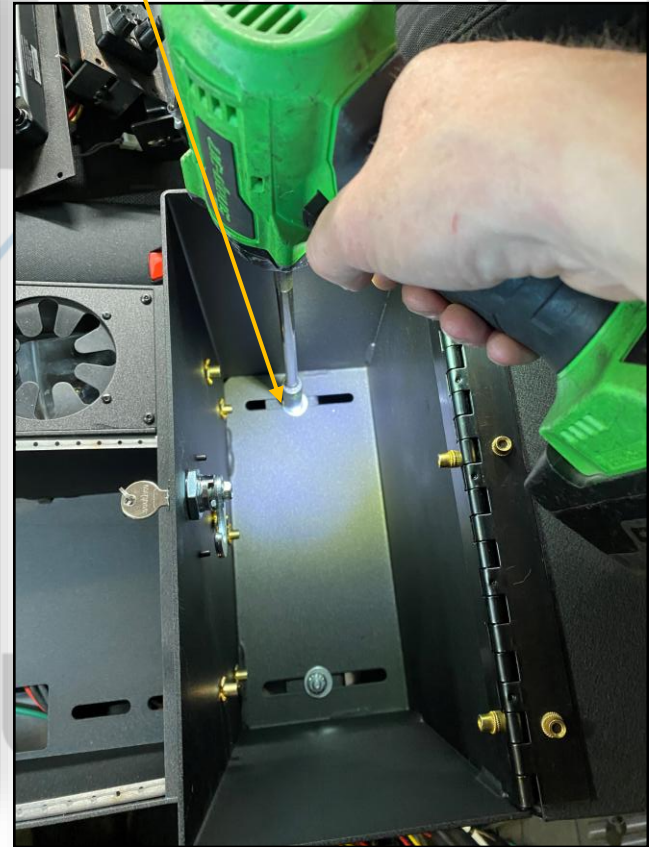



1616 MARLBOROUGH AVE. RIVERSIDE, CA 92507

FOR TECHNICAL ASSISTANCE WITH INSTALLATION OR
OTHER QUESTIONS, PLEASE CALL (951) 222-2270

OR EMAIL SUPPORT@IDSMP.COM

Thank you for your business!