

EMERGENCY EQUIPMENT

INV-ES-FF-ET-PIU20-EXT

INSTALLATION INSTRUCTIONS

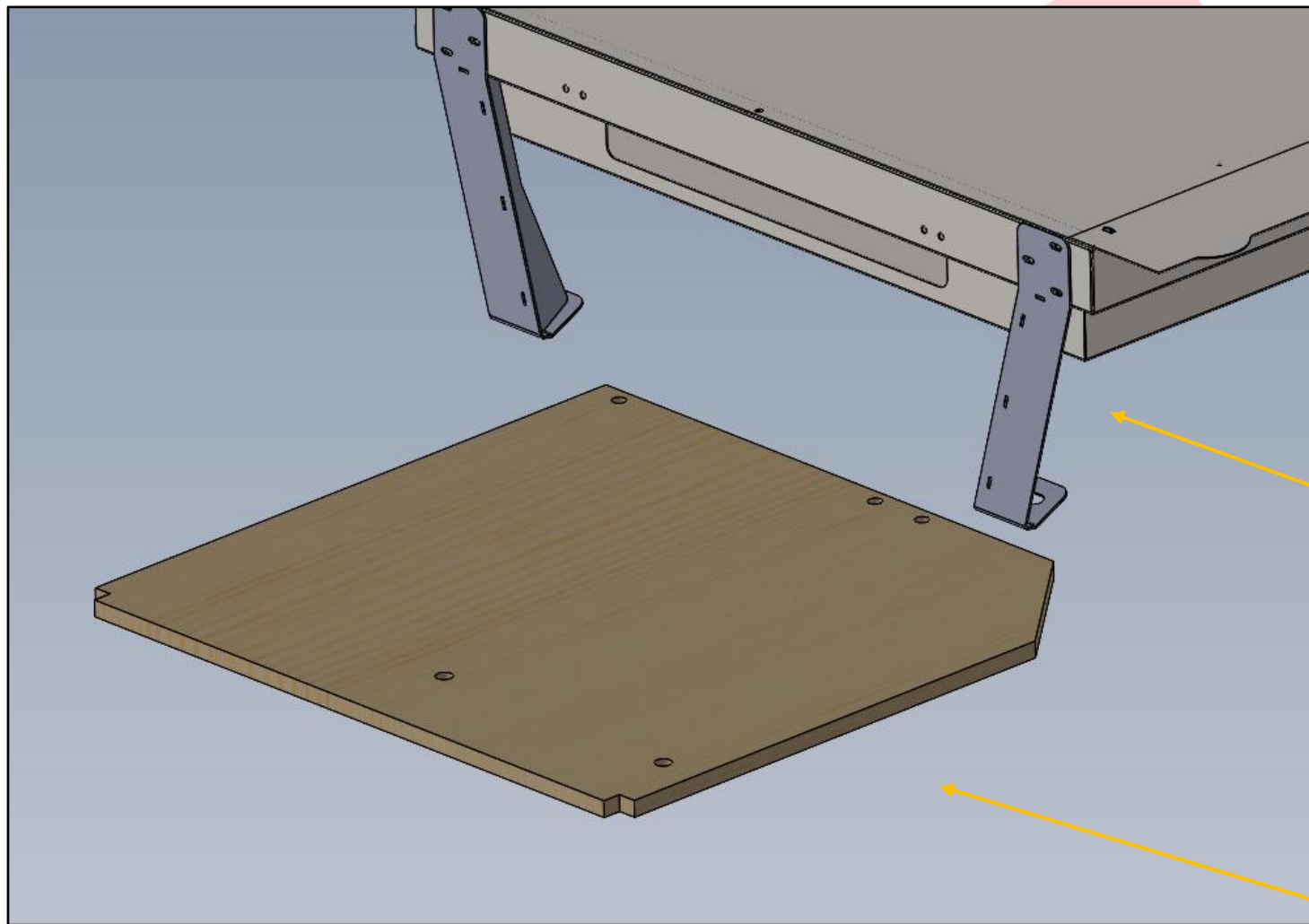

PIU20 FALSE FLOOR EXTENSION INSTALLATION INSTRUCTIONS

INSTALL KIT TO INCLUDE:

1X WOOD FLOOR
1X PIU20 EXTENSION BOX
MOUNTING HARDWARE

STEP 1) INSTALL INV-ES-FF-ET-PIU20 PER
FALSE FLOOR INSTRUCTIONS.

STEP 2) REMOVE REAR SEATS FROM DRIVER
AND MIDDLE POSITIONS IF NOT ALREADY
DONE. SAVE SEAT MOUNTING HARDWARE.

STEP 3) BOLT WOOD PANEL TO VEHICLE
FLOOR USING FACTORY SEAT HARDWARE.

EMERGENCY EQUIPMENT

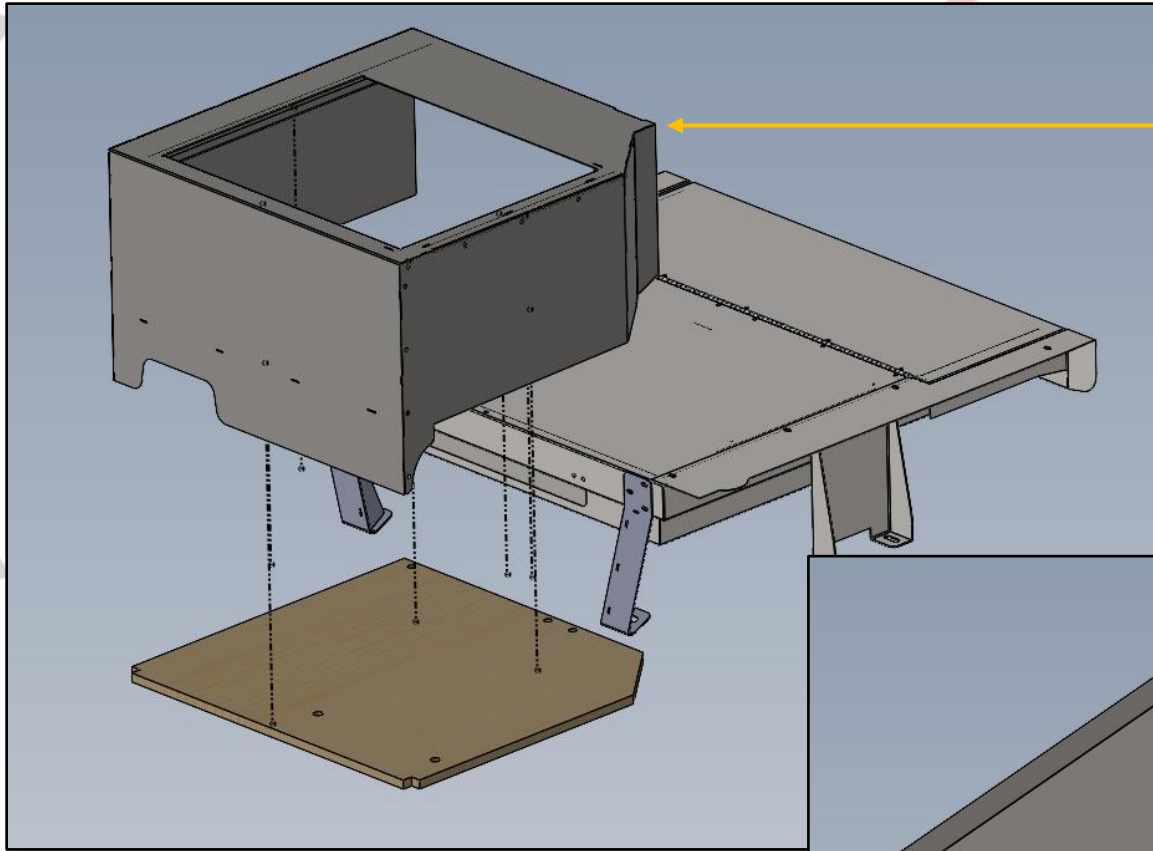

STEP 4) PLACE EXTENSION BOX ON WOOD PANEL. (LID NOT SHOWN FOR CLARITY)

STEP 5) SECURE BOX TO WOOD PANEL WITH PROVIDED SCREWS.

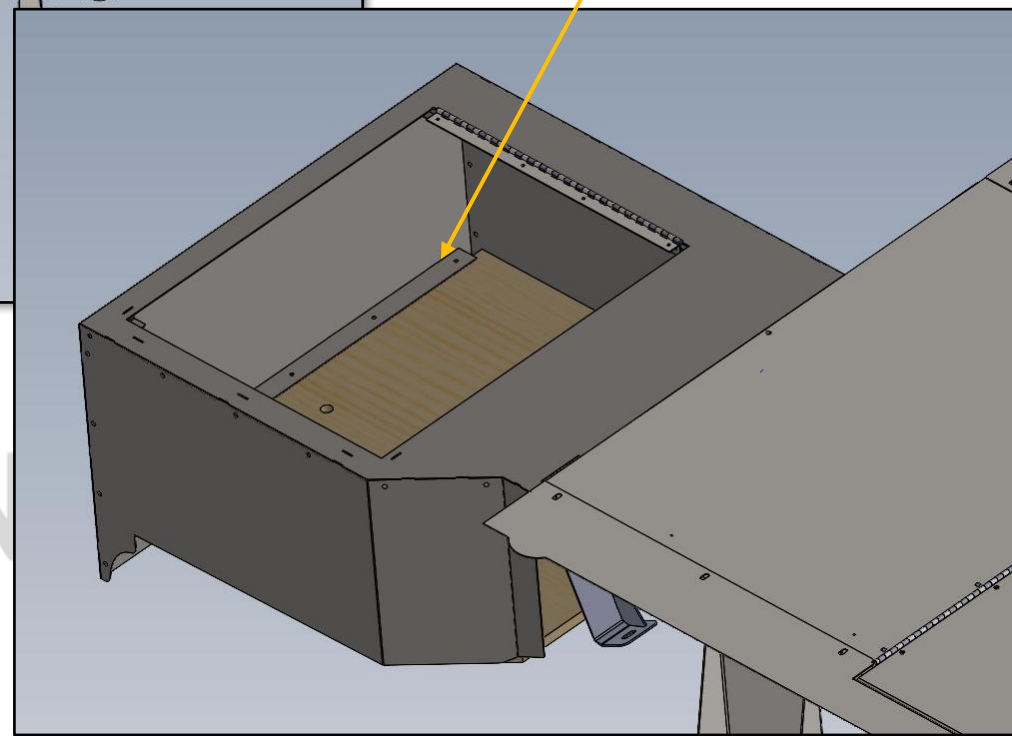

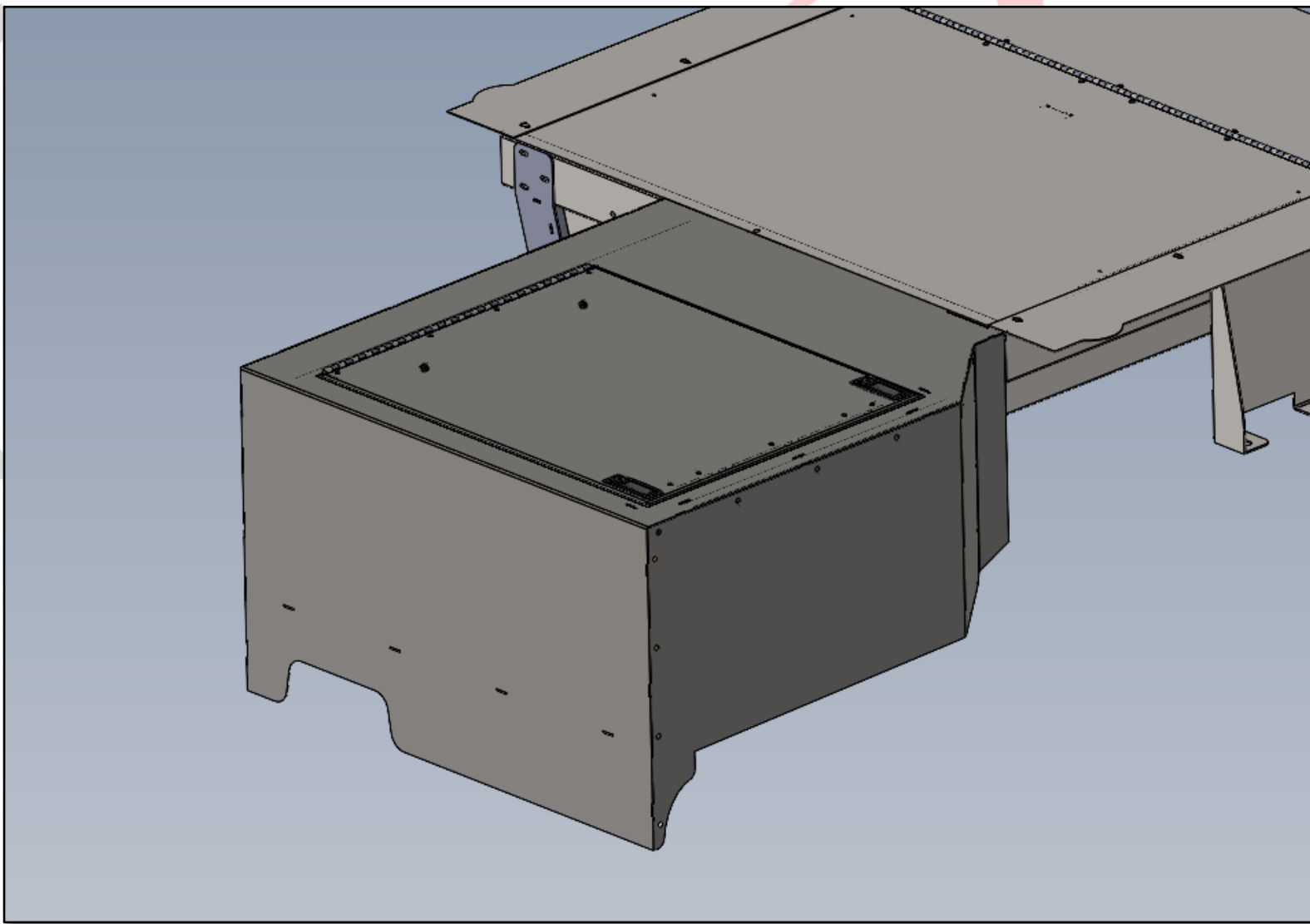

INSTALLATION IS COMPLETE



1616 MARLBOROUGH AVE. RIVERSIDE, CA 92507

FOR TECHNICAL ASSISTANCE WITH INSTALLATION OR
OTHER QUESTIONS, PLEASE CALL (951) 222-2270

OR EMAIL SUPPORT@IDSMP.COM

Thank you for your business!